

## Система за интериорно плъзгане EOS



### технически характеристики

Макс. размер на врата (с две ролки)	1,00m x 3,00m
Дебелина на стъклото	8-10mm
Макс. тегло на вратата (с две ролки)	80Kg
Покритие	Сива елуксация - релса Сатен - ролка EOS

релса

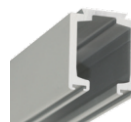

Единична релса 2 метра, код: 22942-670001-2 - 62,40 лв

Единична релса 4 метра, код: 22942-670001 - 122,40 лв

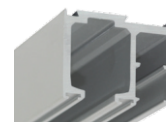





Релса с фикс 2 метра, код: 22942-670003-2 - 86,40 лв

Релса с фикс 4 метра, код: 22942-670003 - 170,40 лв

**Комплект за плъзгане EOS, код: 22629-SL.1158.A.14 - 270.00 лв**

### Комплект за плъзгане EOS

ПРОДУКТ	КОД	ОПИСАНИЕ	КОЛ.
	1170	стопер	1
	1171	стопер със задържане	1
	1152	стоманен подов водач за стъкло	1
	619.50	стоманена дръжка МИДА	1
	1158	EOS ролка с разпробиване ф18	2



Капачка за ед. релса, код: 22942-720033 - 10,40 лв

брави



код: 22629-210.01

Цена: 56,10 лв



код: 22629-227.01

Цена: 84,00 лв

## Схеми и изрези за система EOS

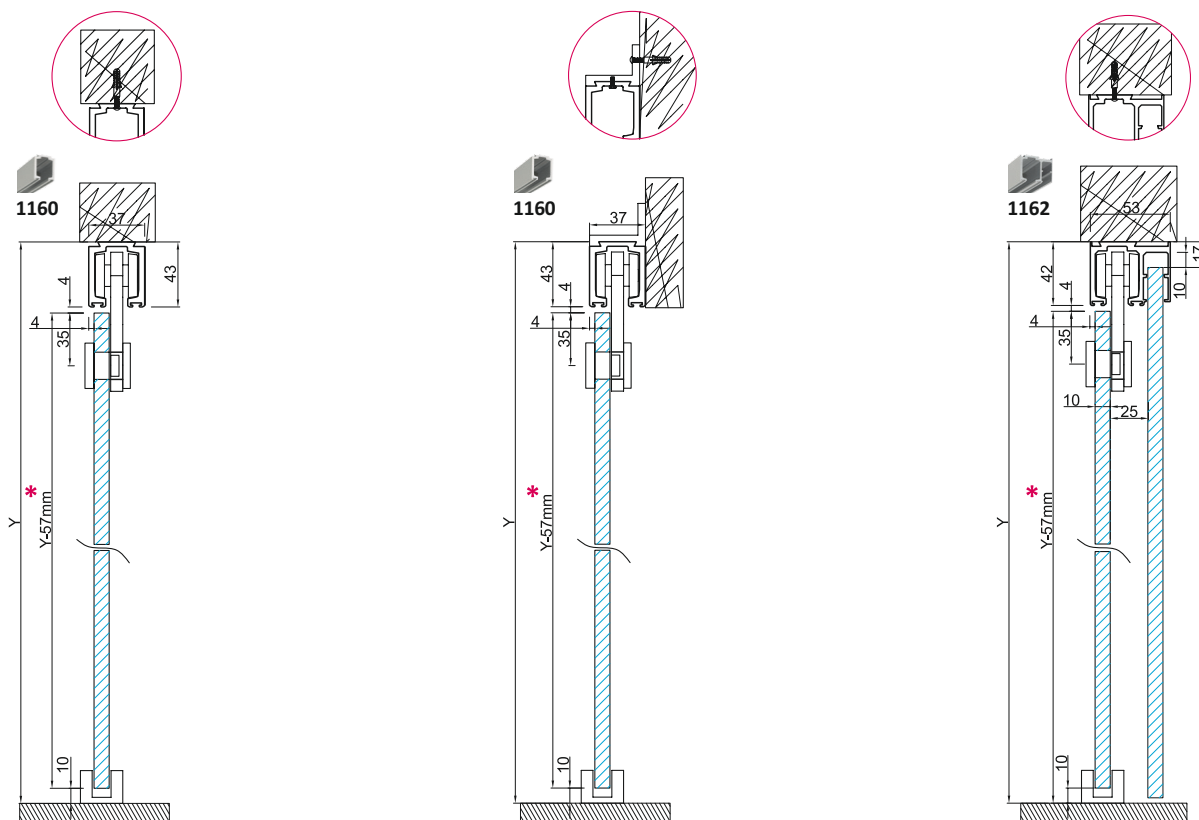

## изрязване стъкло

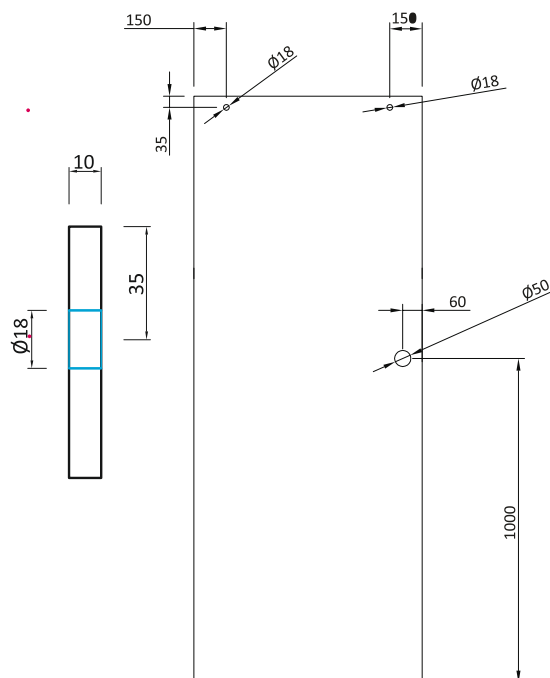
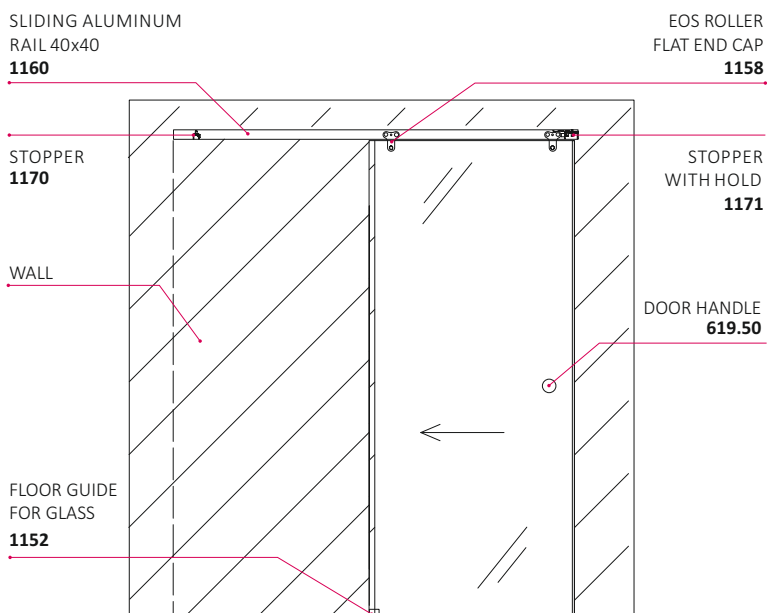

## Плъзгане ESBERG

Плъзгаща система с плавно отваряне и затваряне за интериорни стъклени врати с лапи от неръждаема стомана, до 80 и 130 кг.  
/минимална ширина на вратата 632 мм./  
**/комплект за отвор 1 метър, до 80 кг врата - 533.20 лв с ДДС/**

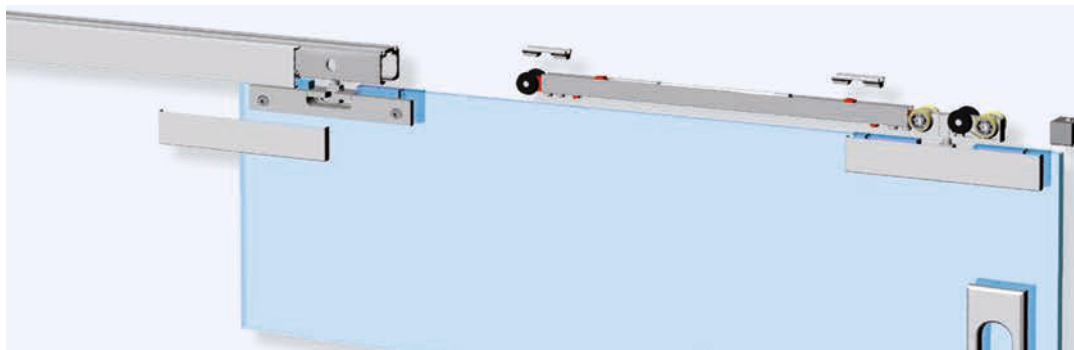

Комплект елементи за 1 врата до 80 кг - Код: 02-5882 - **325,90лв. с ДДС**  
Комплект елементи за 1 врата до 130 кг - Код: 02-5882/130 - **360,00лв. с ДДС**  
комплекта включва - 2 лапи за стъкло, комплект колички с амортизатор, 2 стопера, 2 активатора, подов водач, НЕ включва дръжка/

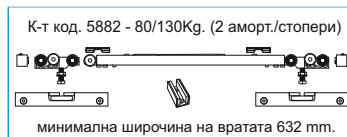

Релса за плъзгане, алуминий - Код: 02-5801 - **64,80лв./метър**  
Профил за фикс, алуминий - Код: 02-5803 - **24,00 лв/метър**  
Покриващ капак, алуминий - Код: 02-5808 - **28,50 лв/метър**  
**Заб.:** - /релси и капаци налични на 6 метра/

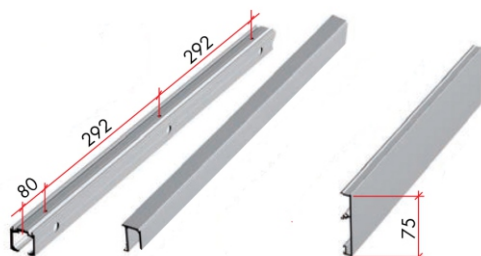
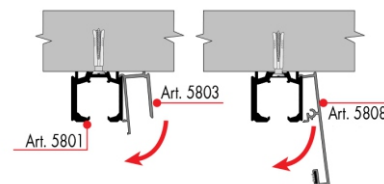

Разпробиване на релсата

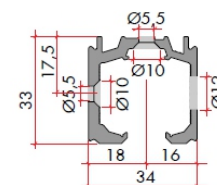

Art. 5801

Art. 5803

Art. 5808

К-т крайни капачки, алуминий - Код: 02-5838 - **21,60 лв**



## Разрези/изгледи

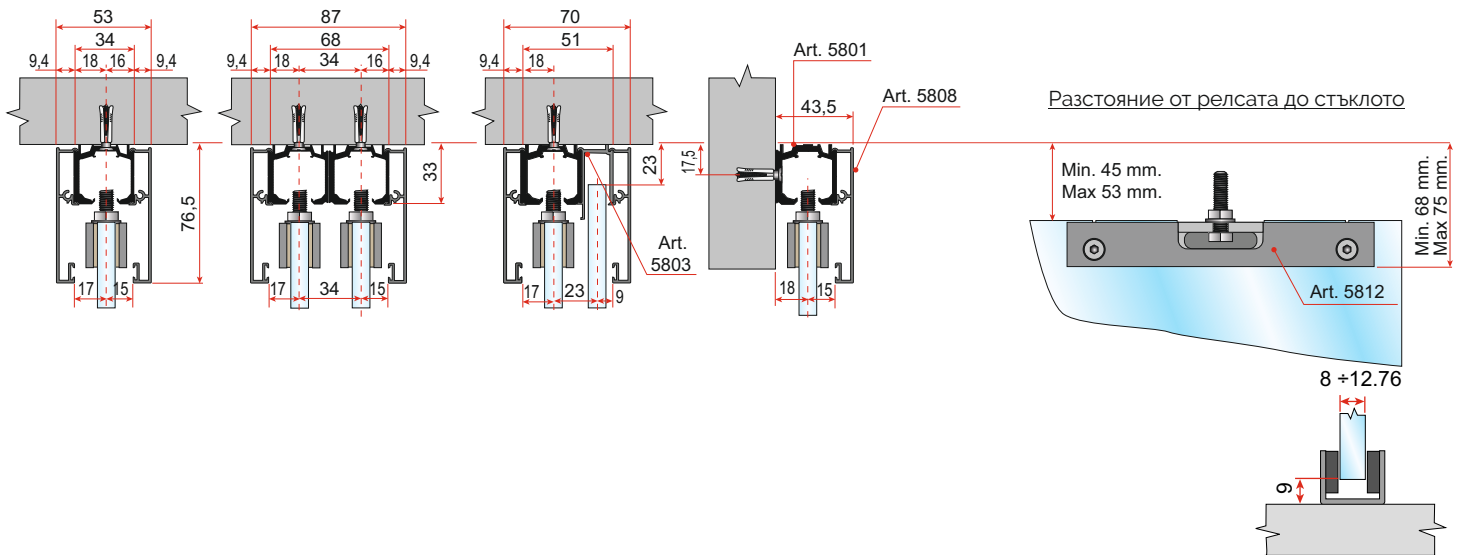

## Обработка на стъклото

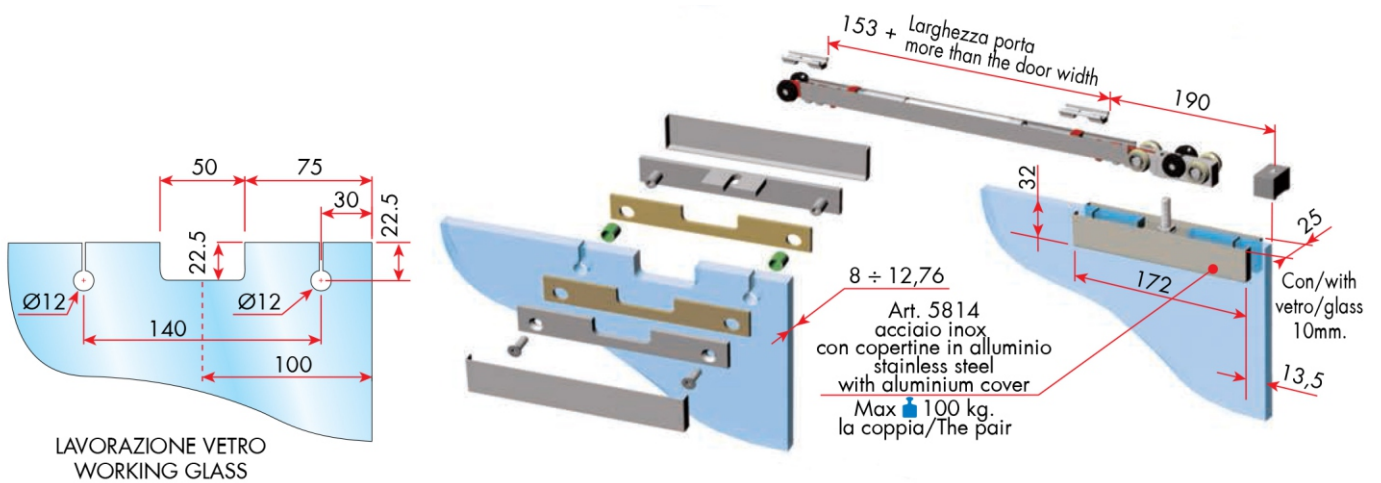



## Плъзгане **ESBERG 2+1**

Плъзгаща система с плавно на отваряне и затваряне за интериорни стъклени и плътни врати за 2 врати (и фикс), телескопично синхронно, с лапи от неръждаема стомана (за стъклени), до 100 кг. на крило минимална ширина на вратата - 600 мм

**/комплект за стъкло, отвор 2 метра - 2 врати, монтаж пред отвор на таван, - 1 497.90 лв с ДДС/**



Комплект елементи за 2 стъклени врати с плавно, телескопично синхронно затваряне и отваряне, до 100 кг на крило, за стъкло от 8 до 12,76 мм

Код: 02-5787 - **1 011,00лв. с ДДС**

/комплекта не включва дръжки/

Комплект елементи за 2 плътни врати с плавно, телескопично синхронно затваряне и отваряне, до 100 кг на крило, за панел до 40 мм дебелина

Код: 02-5777 - **504,00лв. с ДДС**

/комплекта не включва дръжки/

Релса за плъзгане, алуминий -

Код: 02-5801 - **64,80лв./метър**

Профил за фикс, алуминий -

Код: 02-5803 - **24,00 лв/метър**

Покриващ капак 105 мм, алуминий -

Код: 02-5810 - **32,70 лв/метър**

**Заб.:** - /релси и капаци налични 6 метра/

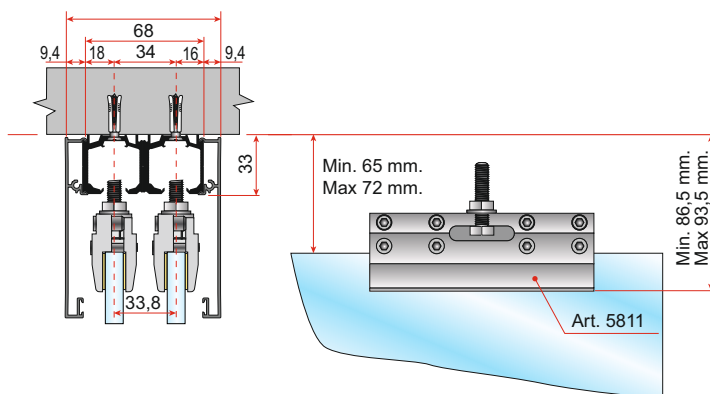

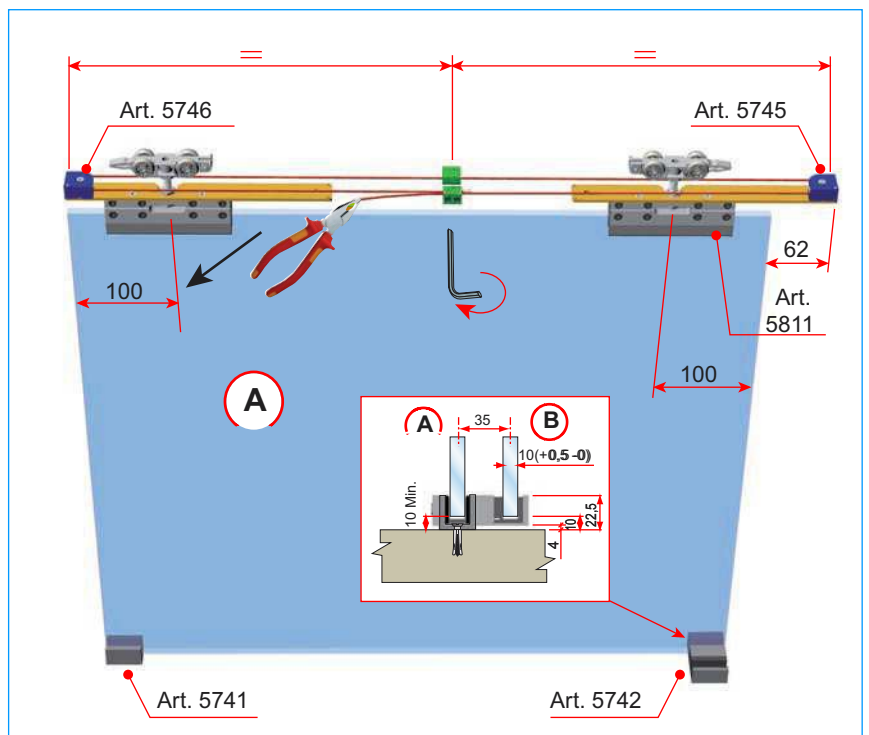
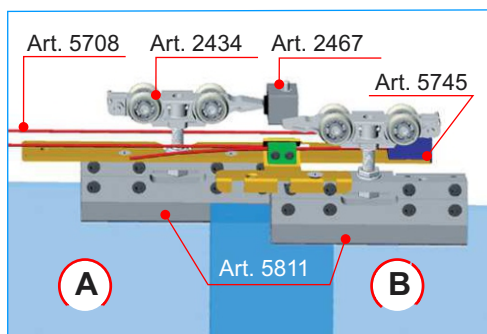
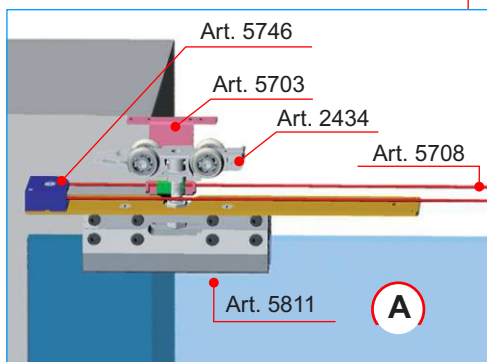
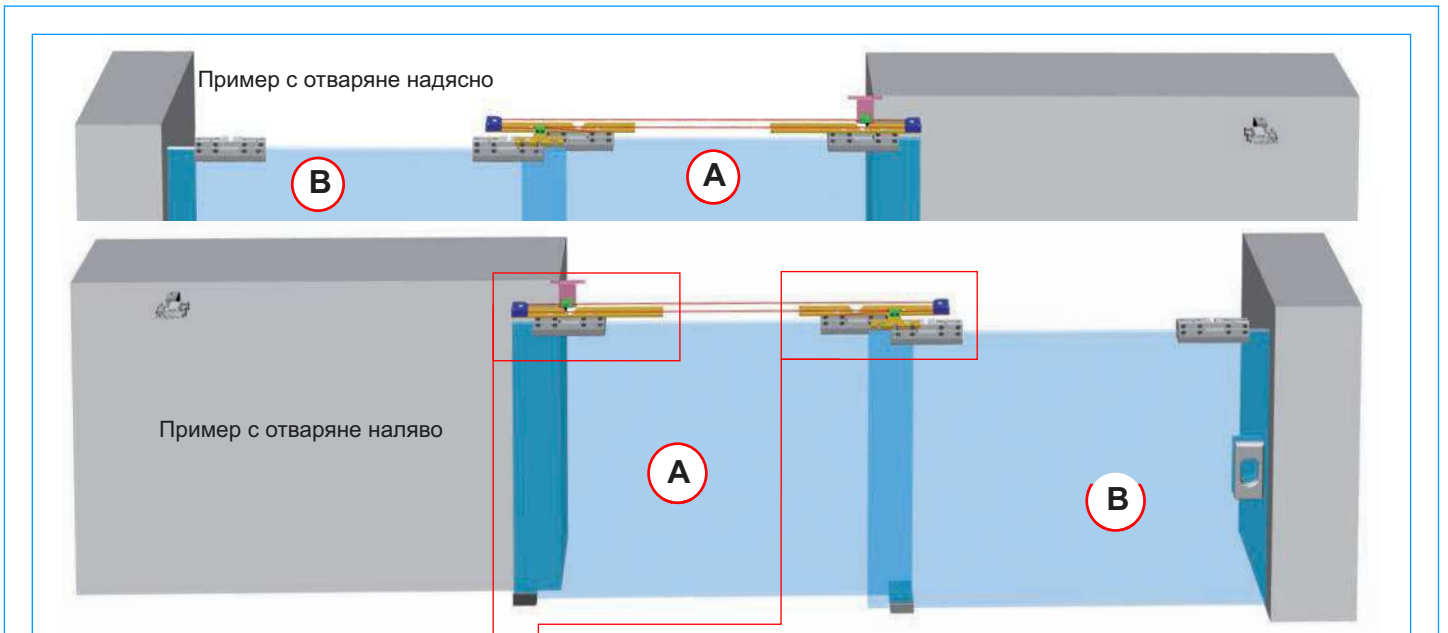
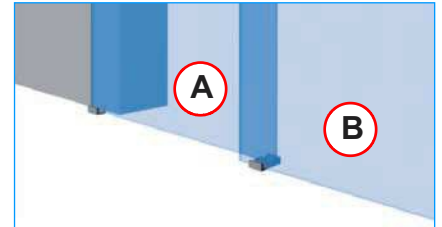
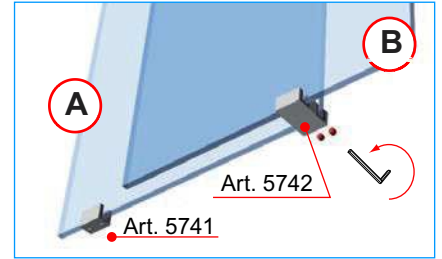
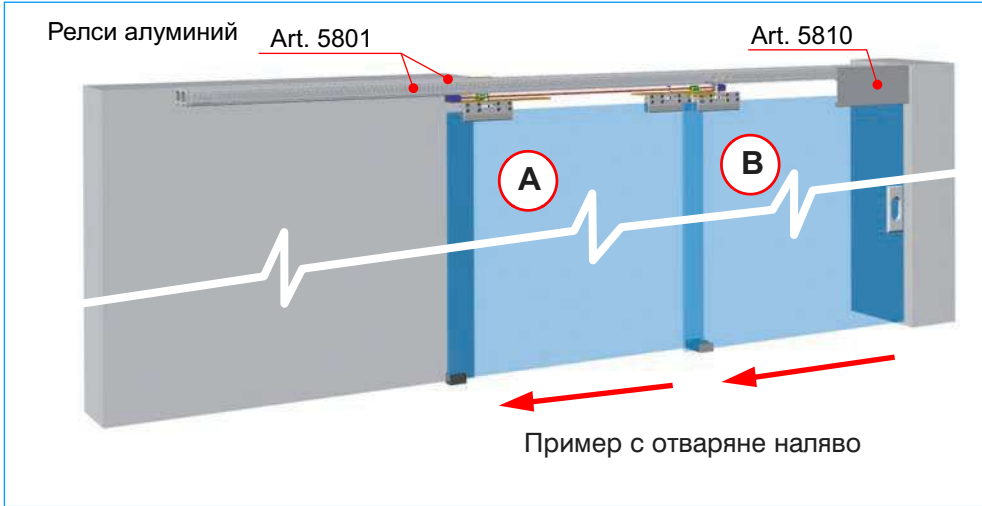

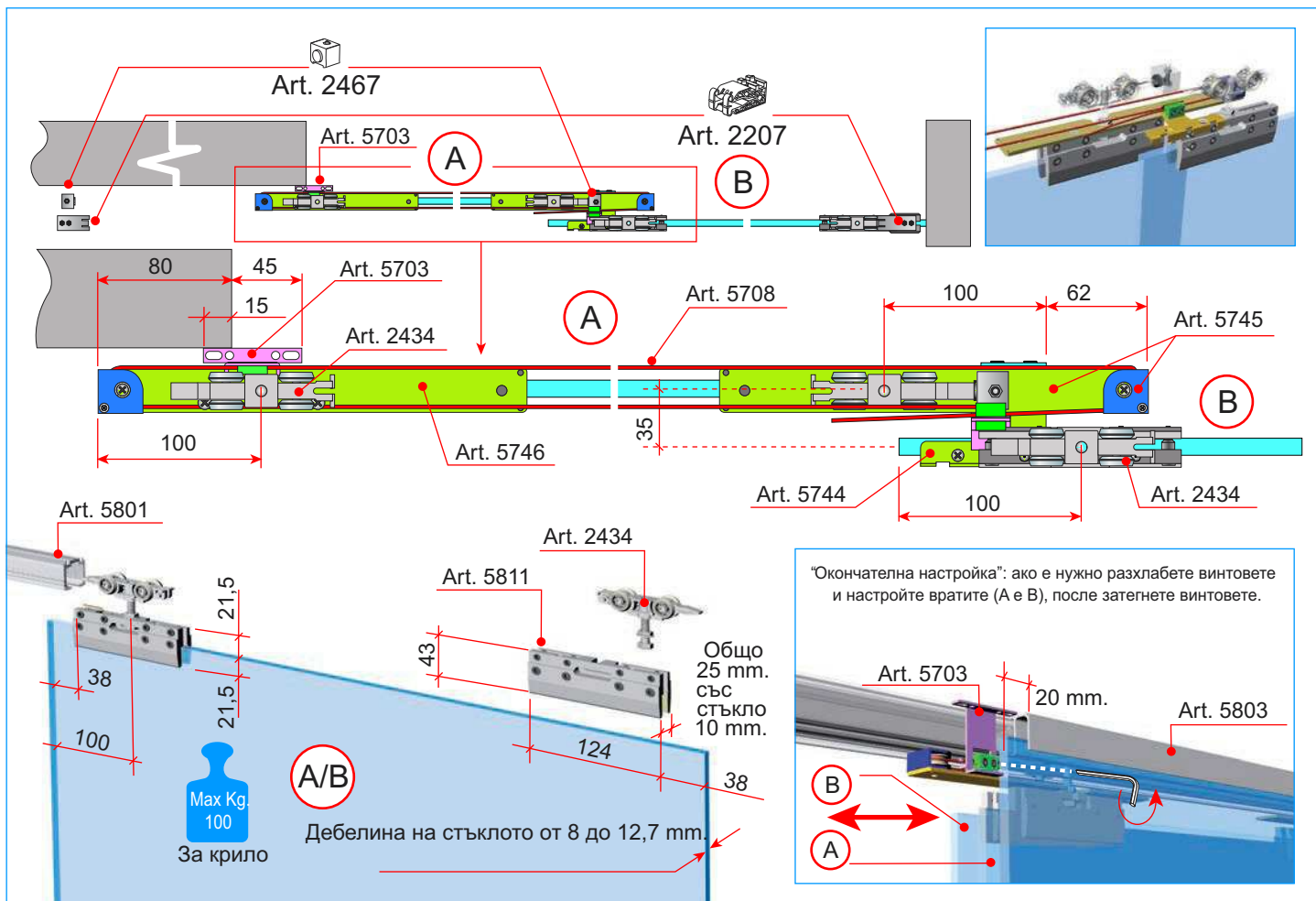
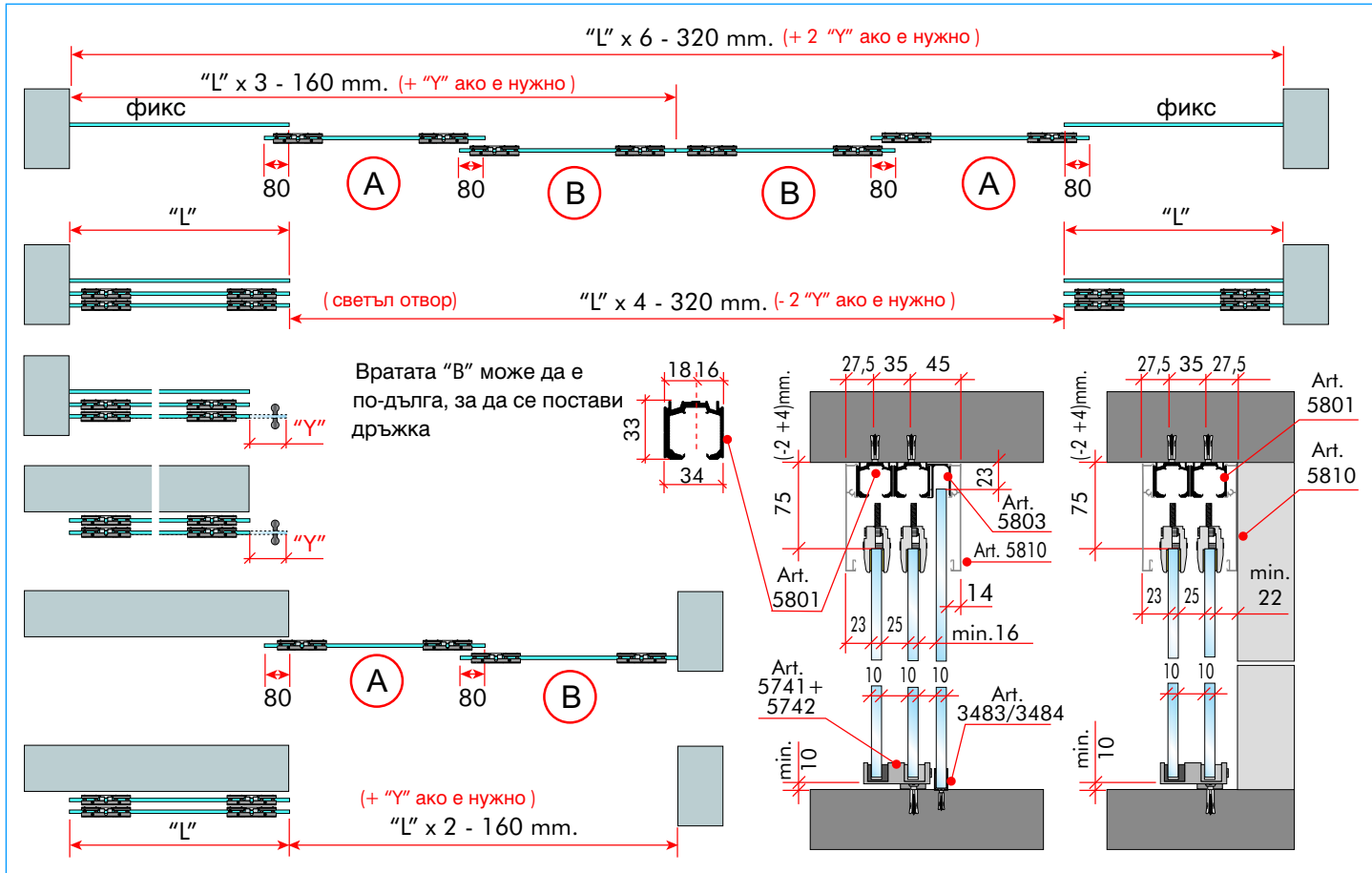

## Разреси/изгледи

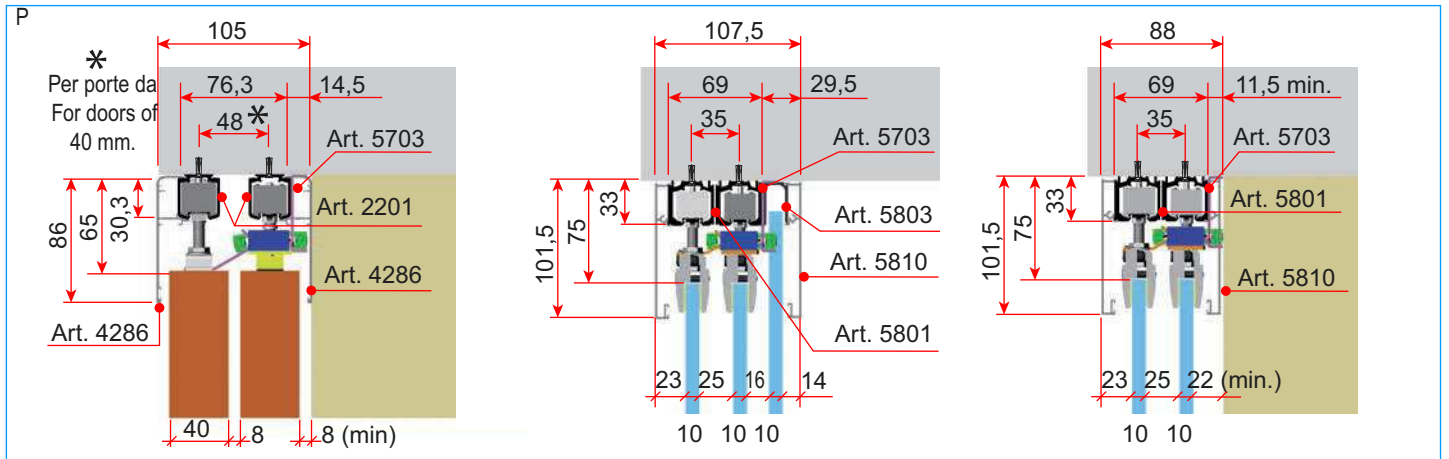

## Инструкции

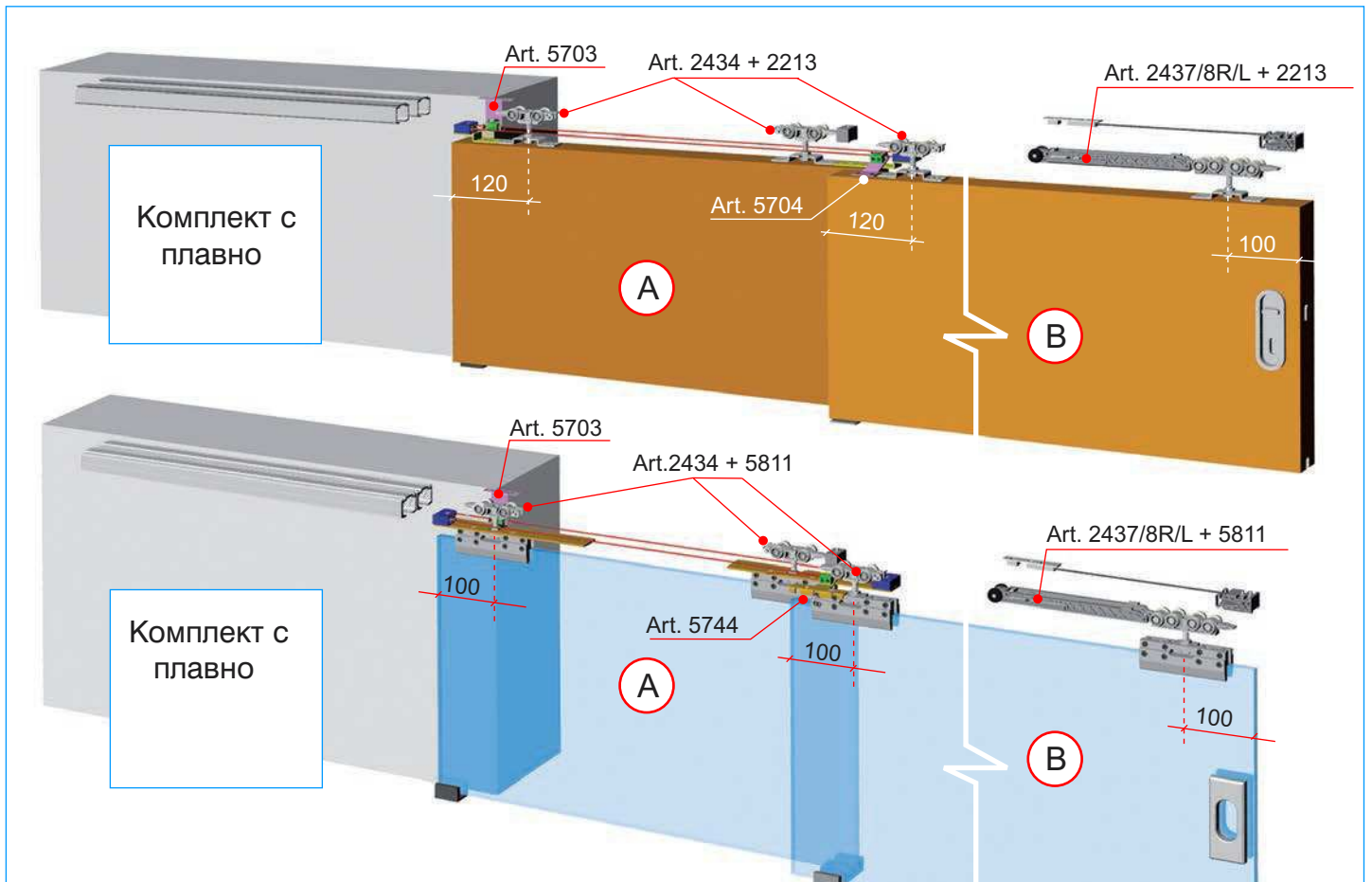
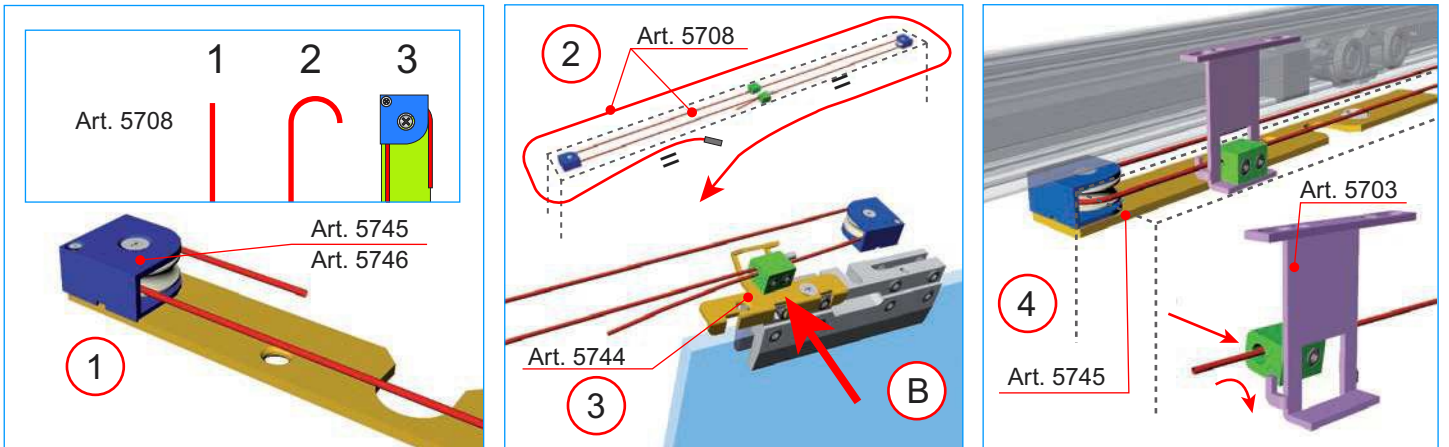



## Механизъм за интериорна плъзгаща стъклена врата с плавно отваряне и затваряне Серия 1000

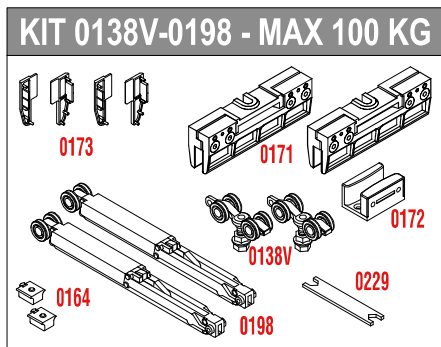

**/комплект за отвор 1 метър, до 40 кг врата - 268.90 лв с ДДС/**



### Kit Legend

<b>0138V</b>	Carrello con 4 cuscinetti Truck with 4 ball-bearings
<b>0198</b>	Decelerante fino a 100kg Soft Closing Stopper up to 100kg
<b>0164</b>	Attivatore Activator
<b>0171</b>	Supporto a pinza per vetro Glass Support
<b>0172</b>	Guida inferiore Lower guide
<b>0173</b>	Tappo x copertura ART.0170 DX-SX Plug for cover ART.0170 DX-SX
<b>0170/1</b>	Copertura alluminio 156mm Aluminium cover 156mm
<b>0229</b>	Chiave di regolazione mm 7-16 Adjusting spanner mm 7-16

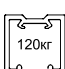
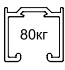
### Legend other items

<b>0196</b>	 Profilo alluminio superiore Upper aluminium profile
<b>0195</b>	 Profilo alluminio superiore Upper aluminium profile
<b>0170</b>	 Copertura in alluminio Aluminium cover
<b>0189</b>	 Staffa a parete regolabile Adjustable wall bracket

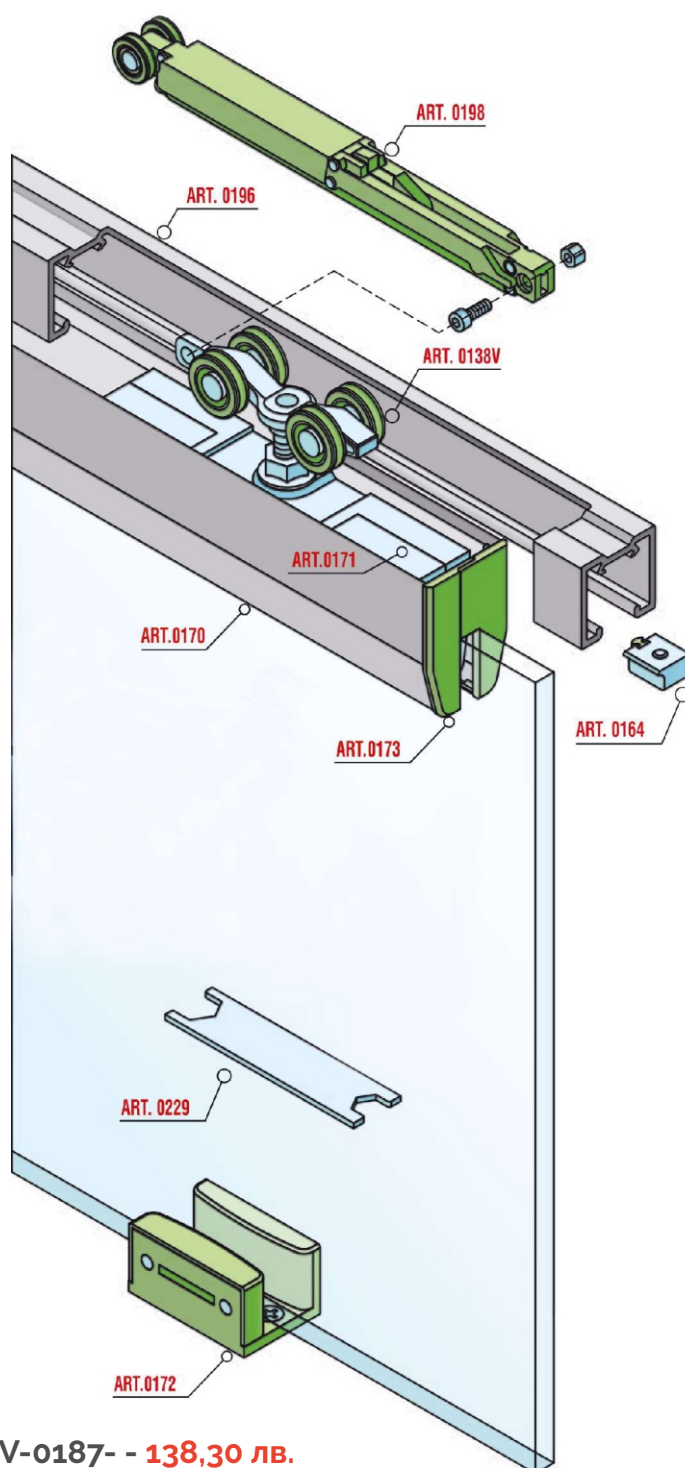

Комплект за врата до 100 кг. - код: **742-0138V-0187** - **138,30 лв.**

Амортисьори до 40 кг. комплект 2 бр. - код: **742-KIT0197** - **54,60 лв.**

Амортисьори до 100 кг. комплект 2 бр. - код: **742-KIT0198** - **67,70 лв.**

Декоративен капак - код: **742-0170A** - **13,00 лв./м** - наличен на 3 метра

Релса плъзгане до 80 кг. - код: **742-0195AF** - **20,00 лв./м** - налична на 6 метра

Релса плъзгане до 120 кг. - код: **742-0196AF** - **32,00 лв./м** - налична на 6 метра

L-образна планка за стена - код: **742-0189** - **2,20 лв./брой**

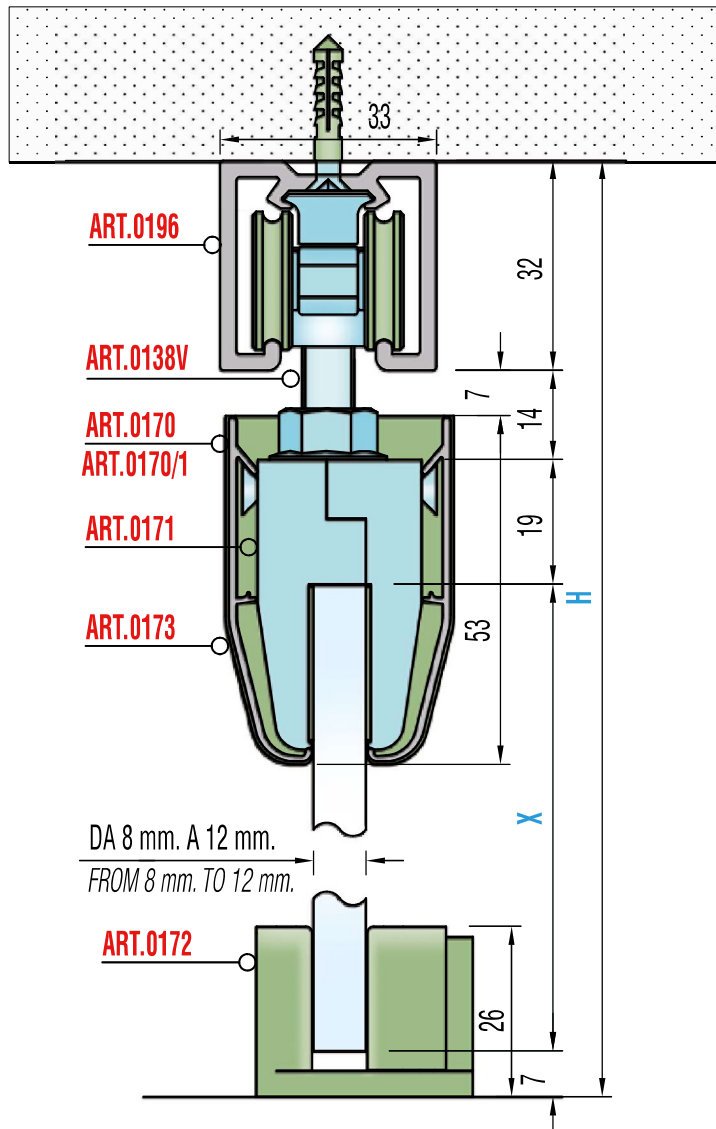

Peso massimo anta Kg. 100  
Maximum door weight Kg 100

H = X - 72

SCHEMA DI MONTAGGIO COPERTURA  
COVER ASSEMBLING INSTRUCTIONS

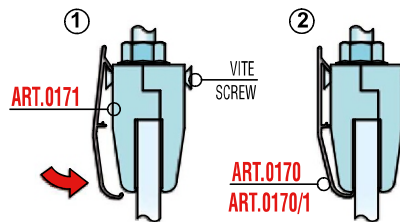

DIMENSIONI GUIDA / GUIDE DIMENSION

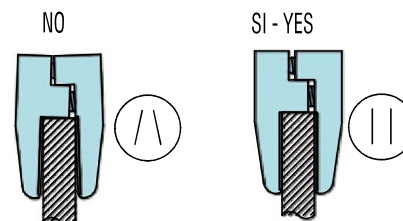
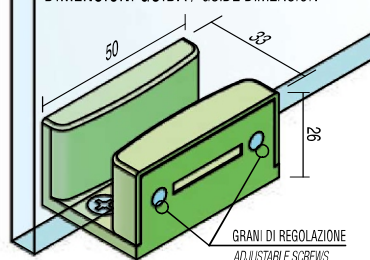

Per la tenuta del sistema verificare il parallelismo a pinza chiusa  
Check the parallelism clamp in the assembled

**Dimensioni standard / Standard dimensions**

A	B
larghezza porta - length of the door	lunghezza binario - length of the track
500-700 mm.	1100 mm.
710-900 mm.	1500 mm.
900-1000 mm.	1700 mm.
910-1200 mm.	1900 mm.

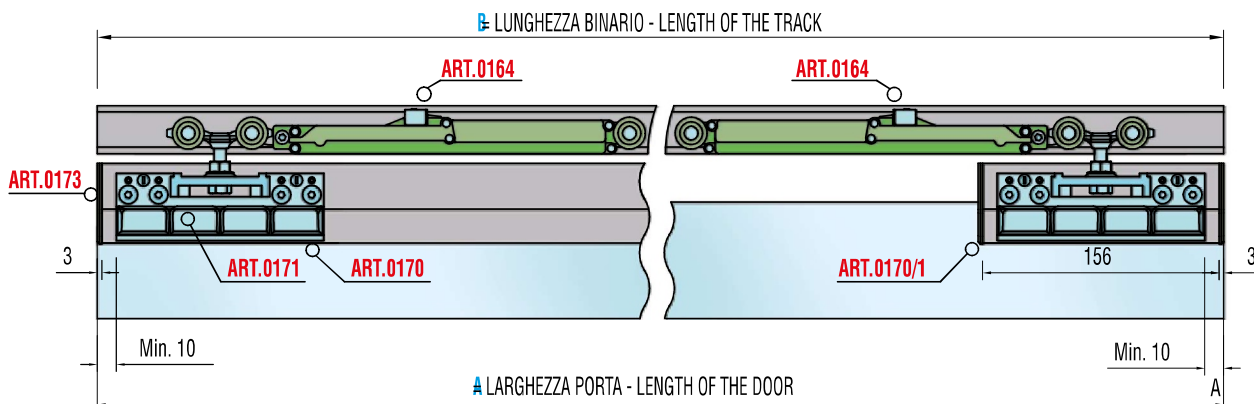



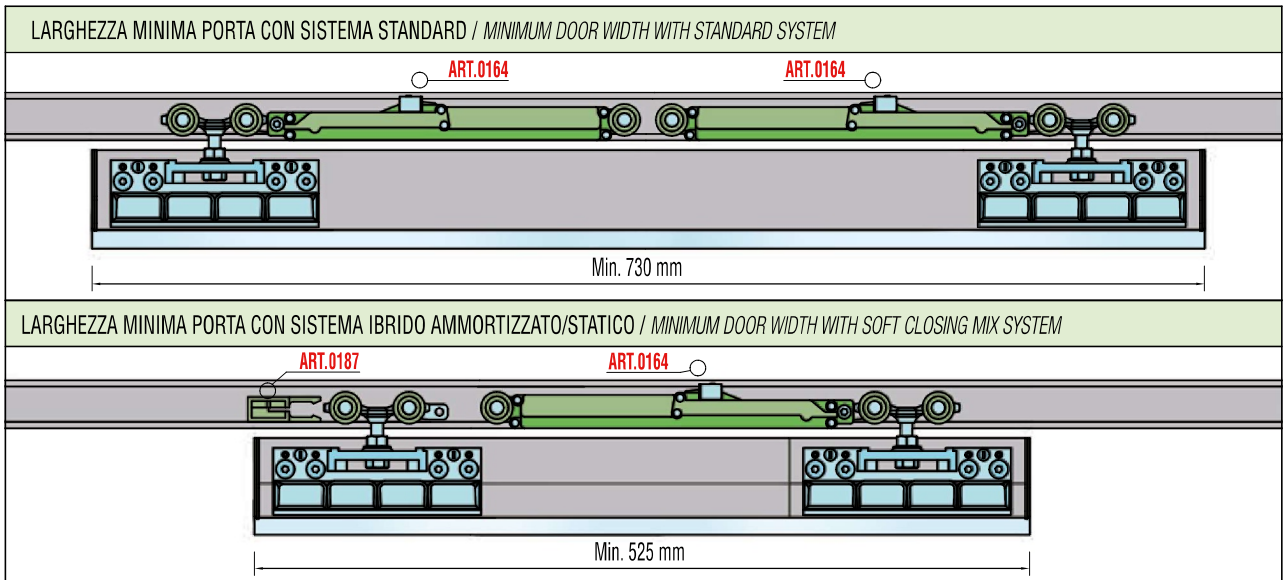

SCHEMA FORATURA ANTE VETRO PER MONTAGGIO ART.0171 / GLASS DOOR DRILLING TO FIT ART.0171

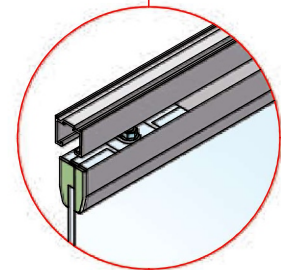
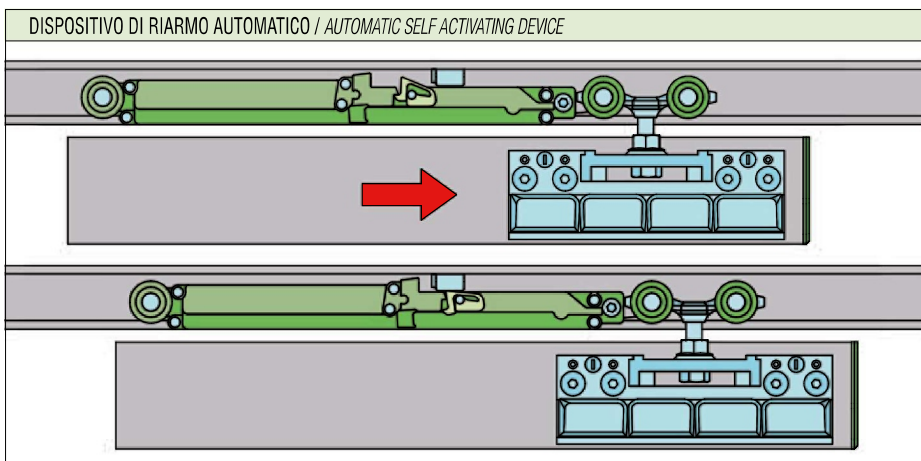
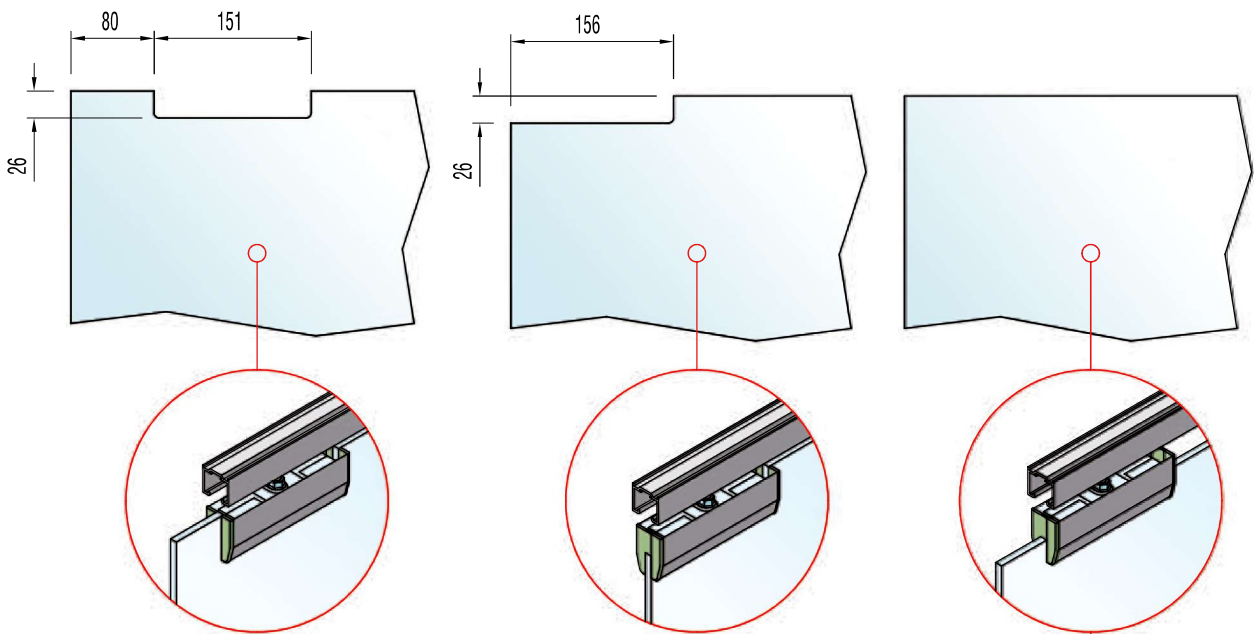

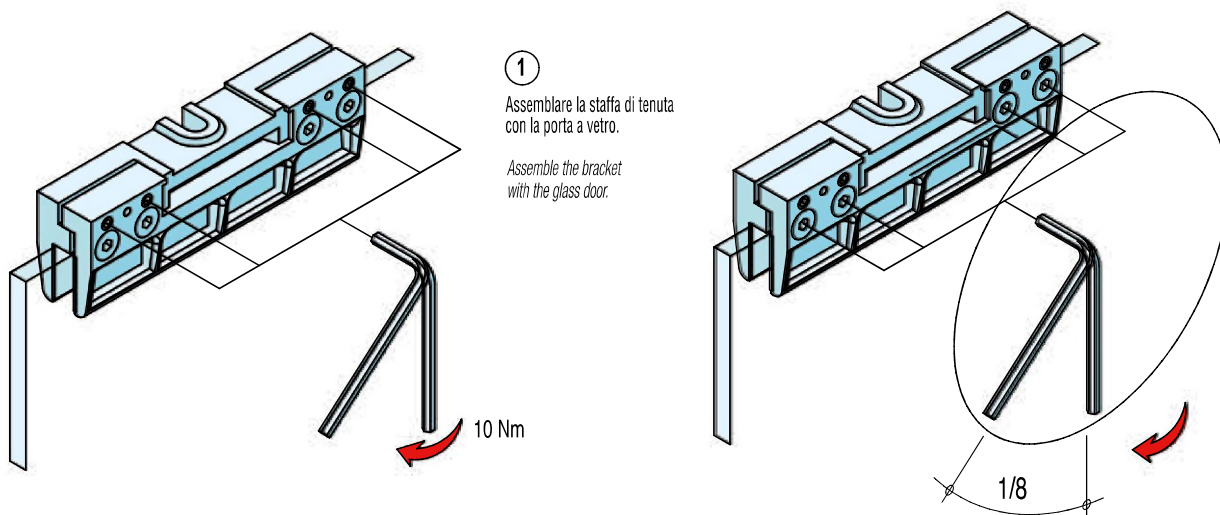

①  
Assemblare la staffa di tenuta  
con la porta a vetro.

*Assemble the bracket  
with the glass door.*

10 Nm

1/8

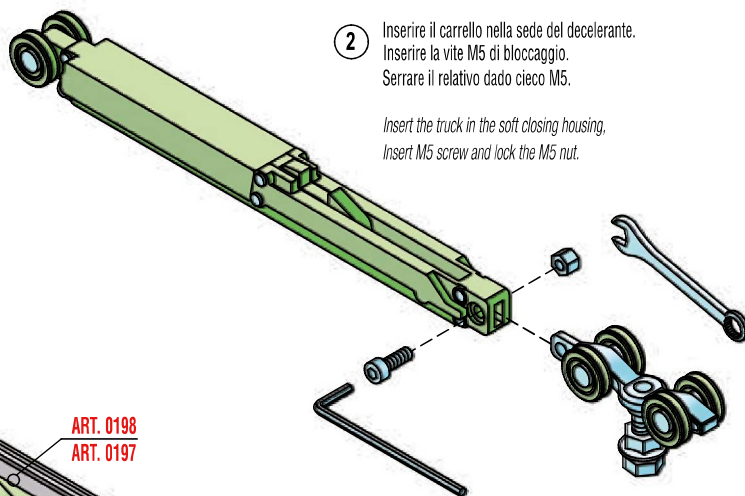

② Inserire il carrello nella sede del decelerante.  
Inserire la vite M5 di bloccaggio.  
Serrare il relativo dado cieco M5.

*Insert the truck in the soft closing housing,  
Insert M5 screw and lock the M5 nut.*

ART. 0195  
ART. 0196

ART. 0198  
ART. 0197

ART. 0138  
ART. 0134

ART. 0164

③

Inserire carrello e decelerante premontati nel relativo binario guida, assemblare il carrello alla staffa di tenuta premontata sulla porta e regolarne successivamente la verticalità tramite l'apposita chiave.

*Insert preassembled truck and soft closing device in their profile, assemble the truck to the preassembled sealing bracket of the door, and then adjust the verticality of the door thanks to the special key.*

④

Inserire l'attivatore nel binario guida nella posizione desiderata serrandolo attraverso il relativo grano di bloccaggio.

*Insert the activator in the profile in the right position and fix it thanks to its locking screw.*

### ATTENZIONE

Bloccare sempre l'attivatore Art.0164 tramite l'apposito grano M5 prima di agganciarlo al decelerante

### WARNING

*Always lock the activator Art.0164 by the relative screw before hooking it to the soft closing device*

## Механизъм за интериорна плъзгаща плътна врата с плавно отваряне и затваряне Серия 1000

**/комплект за отвор 1 метър, до 40 кг врата - 169.80 лв с ДДС/**

### KIT 0138-0197 - MAX 40 KG

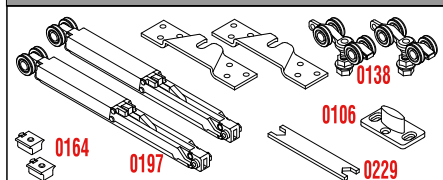

### KIT 0138-0198 - MAX 100 KG

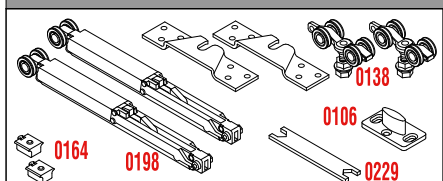

#### Kit Legend

<b>0134</b>	Carrello con 2 cuscinetti Truck with 2 ball-bearings
<b>0138</b>	Carrello con 4 cuscinetti Truck with 4 ball-bearings
<b>0197</b>	Decelerante fino a 40kg Soft Closing Stopper up to 40kg
<b>0198</b>	Decelerante fino a 100kg Soft Closing Stopper up to 100kg
<b>0164</b>	Attivatore Activator
<b>0106</b>	Guida inferiore fissa Fixed lower runner
<b>0229</b>	Chiave di regolazione mm 7-16 Adjusting spanner mm 7-16

#### Legend other items

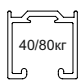
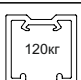
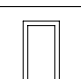
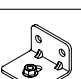
<b>0195</b>	 40/80кг	Profilo alluminio superiore Upper aluminium profile
<b>0196</b>	 120кг	Profilo alluminio superiore Upper aluminium profile
<b>0251</b>		Profilo alluminio inferiore Lower aluminium profile
<b>0189</b>		Staffa a parete regolabile Adjustable wall bracket

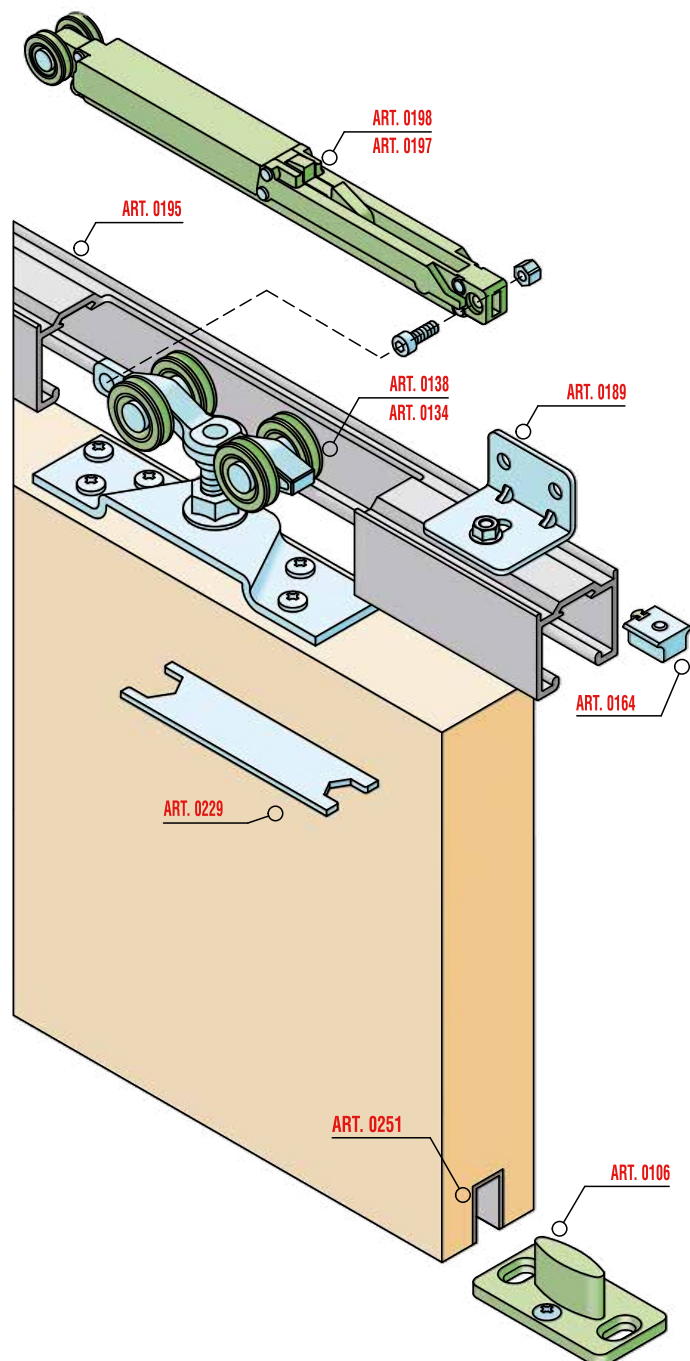

Комплект за врата до 120 кг. - код: **742-0138P** - **52.20 лв.**

Амортисьори до 40 кг. комплект 2 бр. - код: **742-KIT0197** - **54,60 лв.**

Амортисьори до 100 кг. комплект 2 бр. - код: **742-KIT0198** - **67,70 лв.**

Долен профил за вкопаване - код: **742-0251GF** - **12,00 лв./м**

Релса плъзгане до 80 кг. - код: **742-0195AF** - **20,00 лв./м** - налична на 6 метра

Релса плъзгане до 120 кг. - код: **742-0196AF** - **32,00 лв./м** - налична на 6 метра

L-образна планка за стена - код: **742-0189** - **2,20 лв./брой**

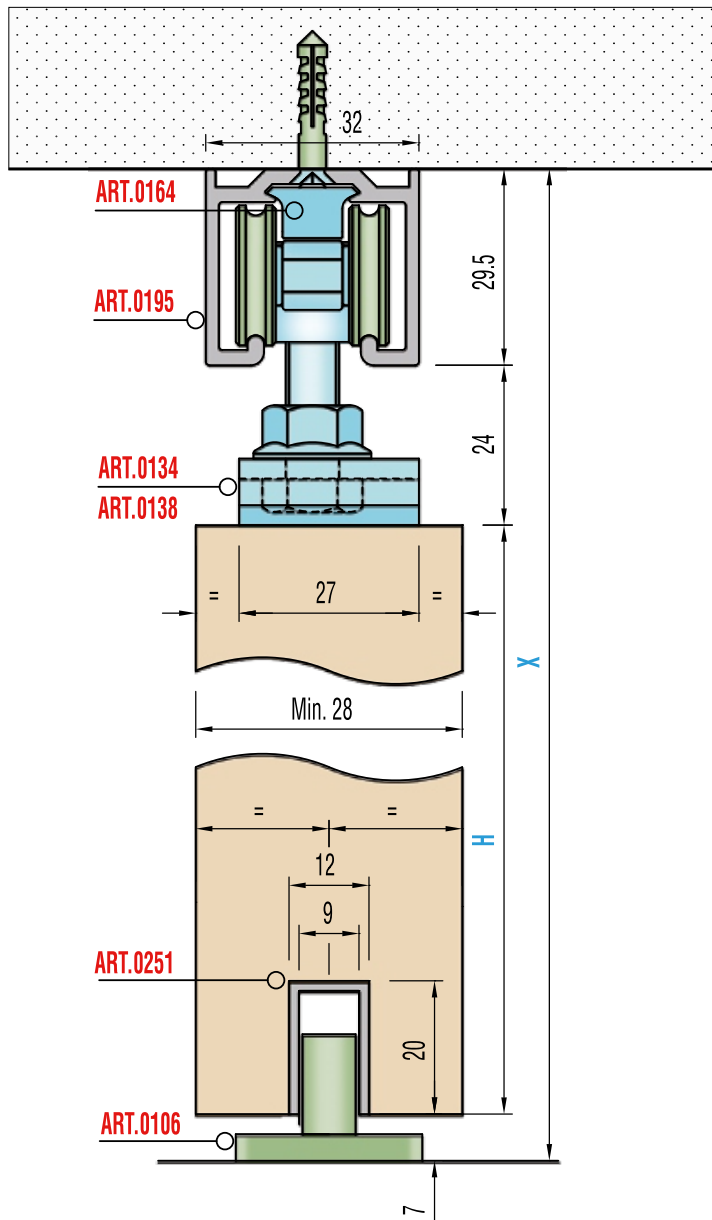

Peso massimo anta Kg. 40 (KIT 0134-0197)  
Maximum door weight Kg 40 (KIT 0134-0197)

Peso massimo anta Kg. 80 (KIT 0138-0198)  
Maximum door weight Kg 80 (KIT 0138-0198)

H = X - 60.5

Distanza minima porta - binario  
Minimum distance between door and profile

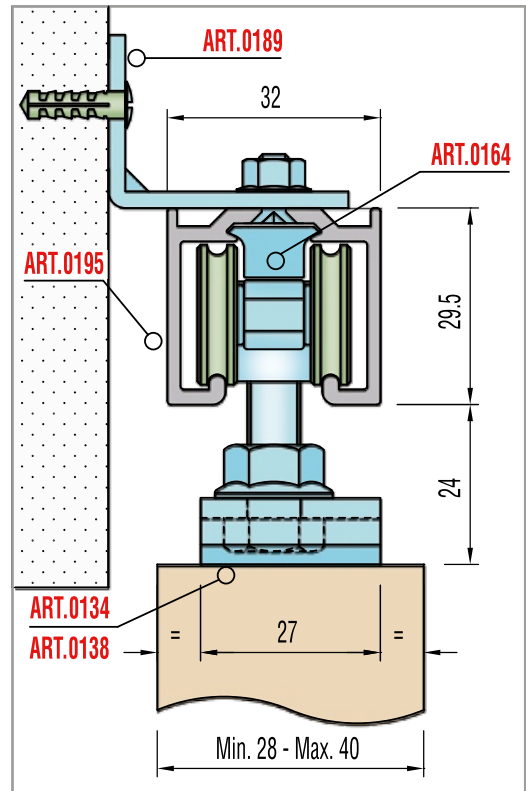

A	B
larghezza porta - length of the door	lunghezza binario - length of the track
500-700 mm.	1100 mm.
710-900 mm.	1500 mm.
900-1000 mm.	1700 mm.
910-1200 mm.	1900 mm.

## Dimensioni standard / Standard dimensions

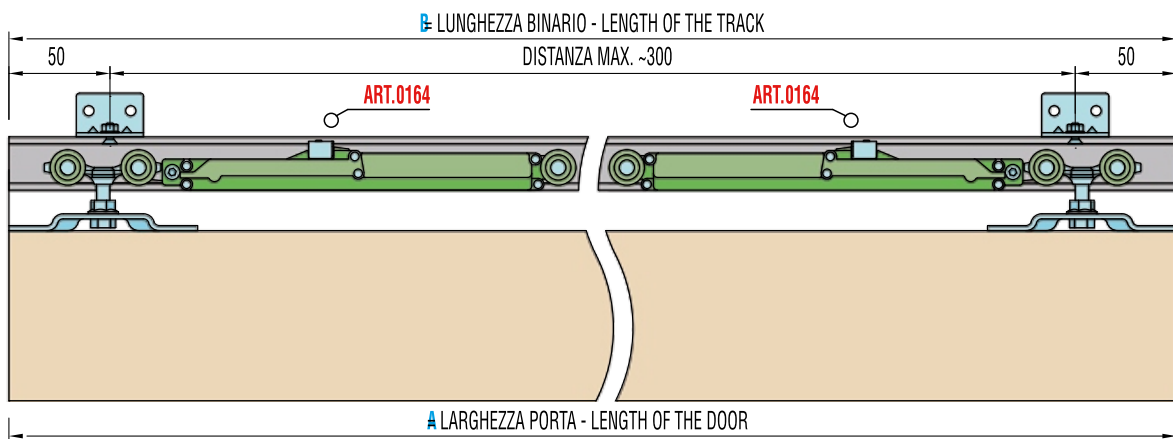

B LUNGHEZZA BINARIO - LENGTH OF THE TRACK

DISTANZA MAX. ~300

A LARGHEZZA PORTA - LENGTH OF THE DOOR



**LARGHEZZA MINIMA PORTA CON SISTEMA STANDARD / MINIMUM DOOR WIDTH WITH STANDARD SYSTEM**

Min. 680 mm

---

**LARGHEZZA MINIMA PORTA CON SISTEMA IBRIDO AMMORTIZZATO/STATICO / MINIMUM DOOR WIDTH WITH SOFT CLOSING MIX SYSTEM**

20 min  
Min. 465 mm

---

**DISPOSITIVO DI RIARMO AUTOMATICO / AUTOMATIC SELF ACTIVATING DEVICE**

<b>0134</b>	Carrello con 2 cuscinetti <i>Truck with 2 ball-bearings</i>
<b>0138</b>	Carrello con 4 cuscinetti <i>Truck with 4 ball-bearings</i>
<b>0197</b>	Decelerante fino a 40kg <i>Soft Closing Stopper up to 40kg</i>
<b>0198</b>	Decelerante fino a 100kg <i>Soft Closing Stopper up to 100kg</i>
<b>0164</b>	Attivatore <i>Activator</i>
<b>0106</b>	Guida inferiore fissa <i>Fixed lower runner</i>
<b>0195</b>	Profilo alluminio superiore <i>Upper aluminium profile</i>
<b>0196</b>	Profilo alluminio superiore <i>Upper aluminium profile</i>
<b>0251</b>	Profilo alluminio inferiore <i>Lower aluminium profile</i>

**1** Inserire il carrello nella sede del decelerante. Inserire la vite M5 di bloccaggio. Serrare il relativo dado cieco M5.  
*Insert the truck in the soft closing housing, Insert M5 screw and lock the M5 nut.*

**2** Inserire carrello e decelerante premontati nel relativo binario guida, assemblare il carrello alla staffa di tenuta premontata sulla porta e regolarne successivamente la verticalita' tramite l'apposita chiave.  
*Insert preassembled truck and soft closing device in their profile, assemble the truck to the preassembled sealing bracket of the door, and then adjust the verticality of the door thanks to the special key.*

**3** Inserire l'attivatore nel binario guida nella posizione desiderata serrandolo attraverso il relativo grano di bloccaggio.  
*Insert the activator in the profile in the right position and fix it thanks to its locking screw.*

**ATTENZIONE**  
Bloccare sempre l'attivatore Art.0164 tramite l'apposito grano M5 prima di agganciarlo al decelerante

**WARNING**  
Always lock the activator Art.0164 by the relative screw before hooking it to the soft closing device

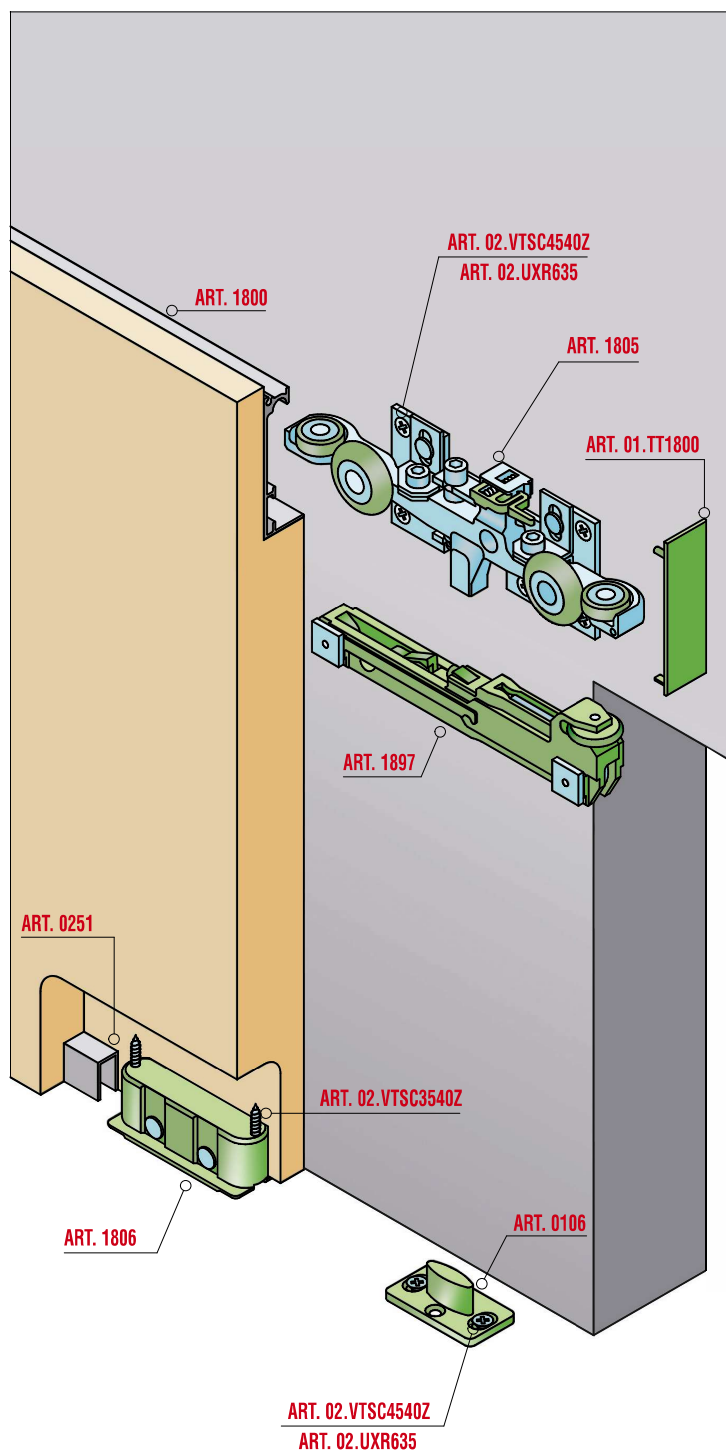
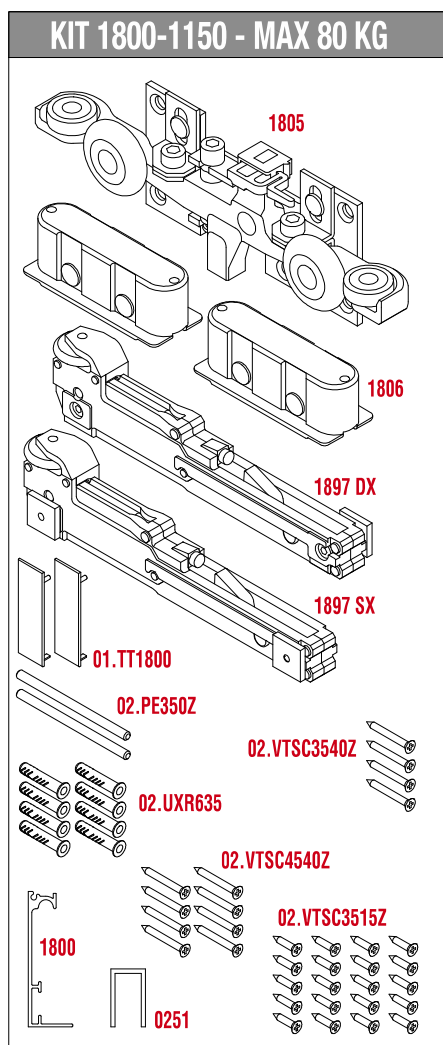

### Kit Legend

<b>1MOG</b>	Guida superiore regolabile <i>Adjustable upper truck</i>
<b>1MOI</b>	Carrello inferiore <i>Lower truck</i>
<b>010I</b>	Guida inferiore <i>Lower runner</i>
<b>01-1M00</b>	Tappo terminale <i>End cover</i>
<b>1MTK</b>	Decelerante <i>Soft Closing Stopper</i>
<b>05-8G0</b>	Perno <i>Pin</i>
<b>05-8GA0</b>	Vite 3.5x40 <i>Screw 3.5x40</i>
<b>05-AGA0</b>	Vite 4.5x40 <i>Screw 4.5x40</i>
<b>05-18G</b>	Tassello <i>Dowel</i>
<b>1M00</b>	Profilo superiore <i>Upper profile</i>
<b>05G1</b>	Profilo inferiore <i>Lower profile</i>

Комплект за врати до 40 кг. код: 1800-1150/40

- 395,00 лв.

Комплект за врати до 80 кг. код: 1800-1150

- 395,00 лв.



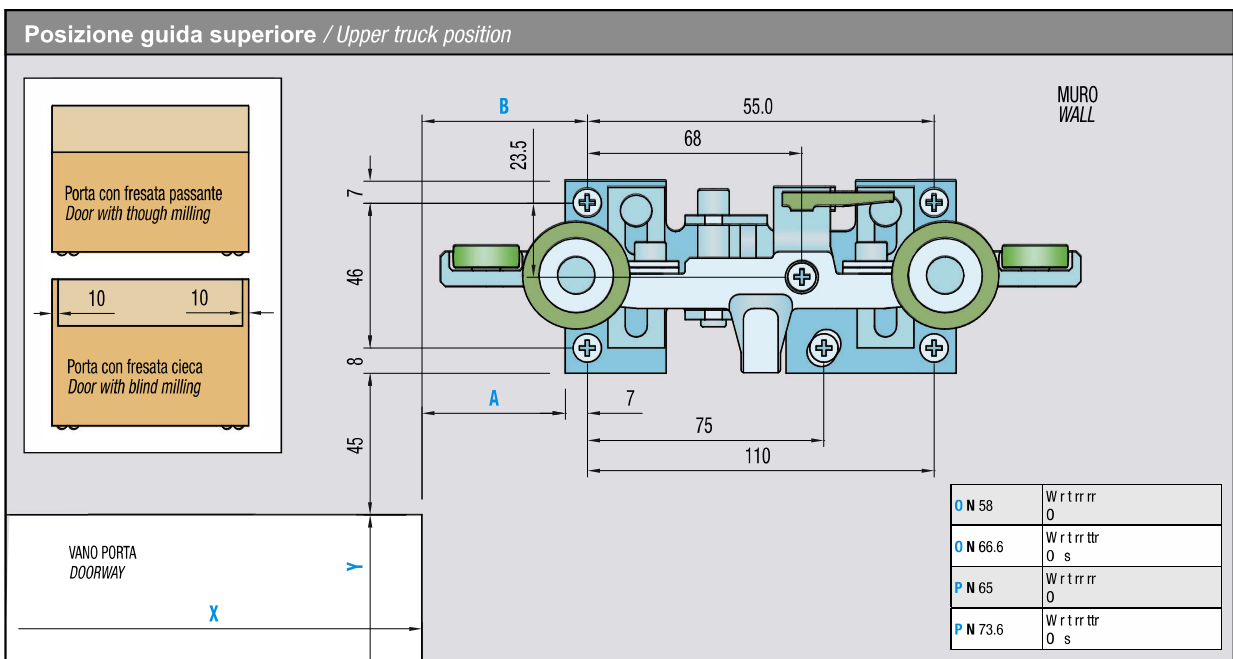
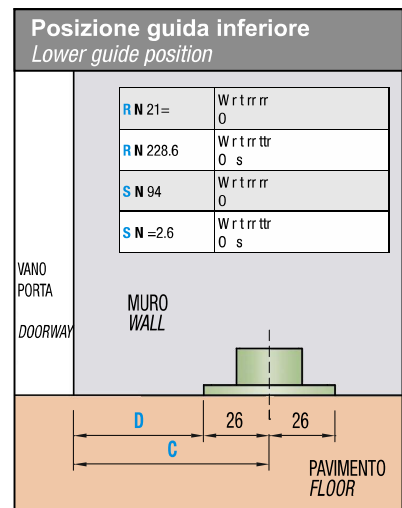
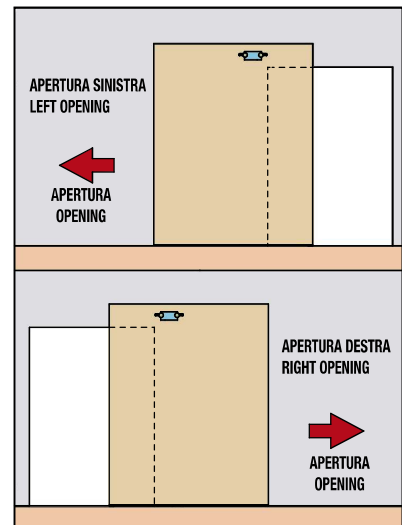
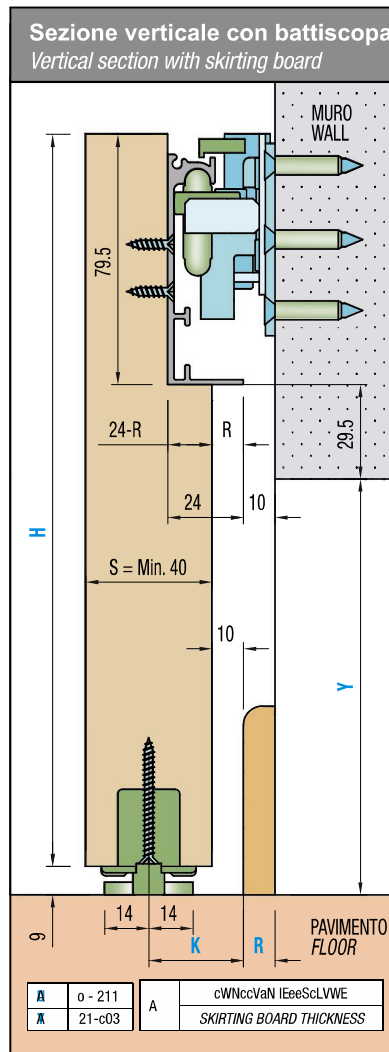
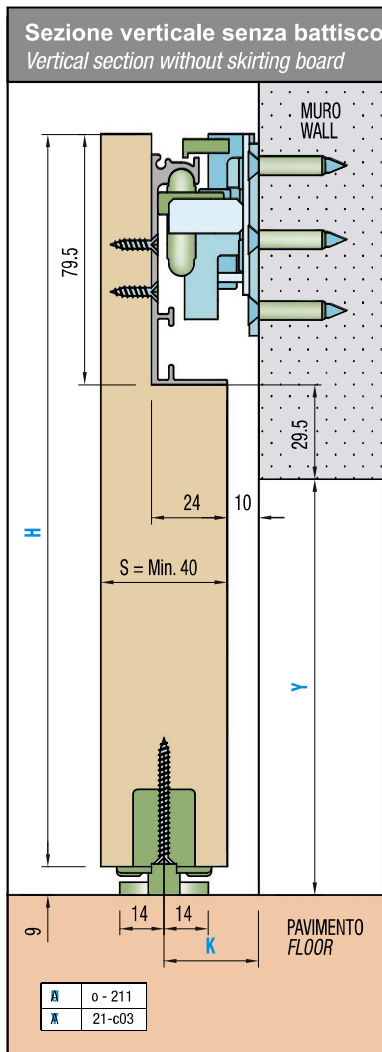

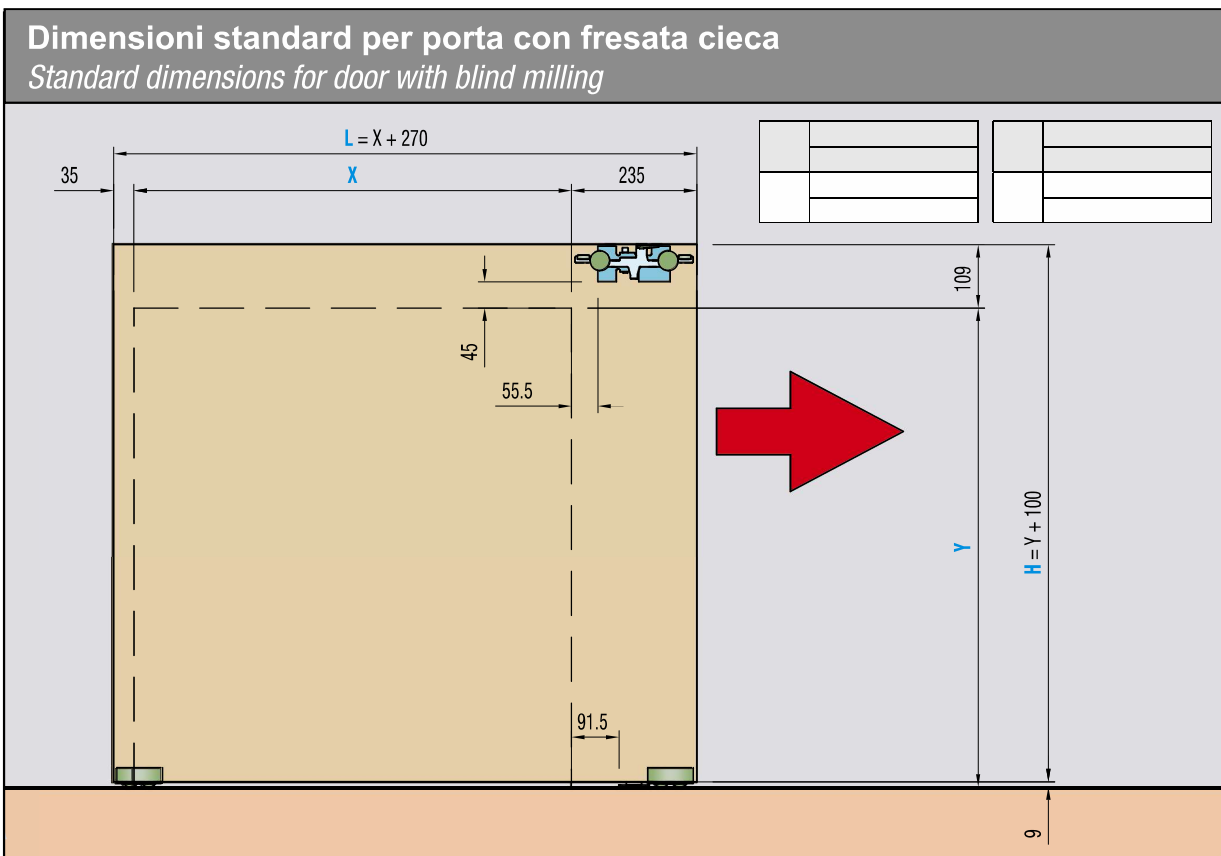
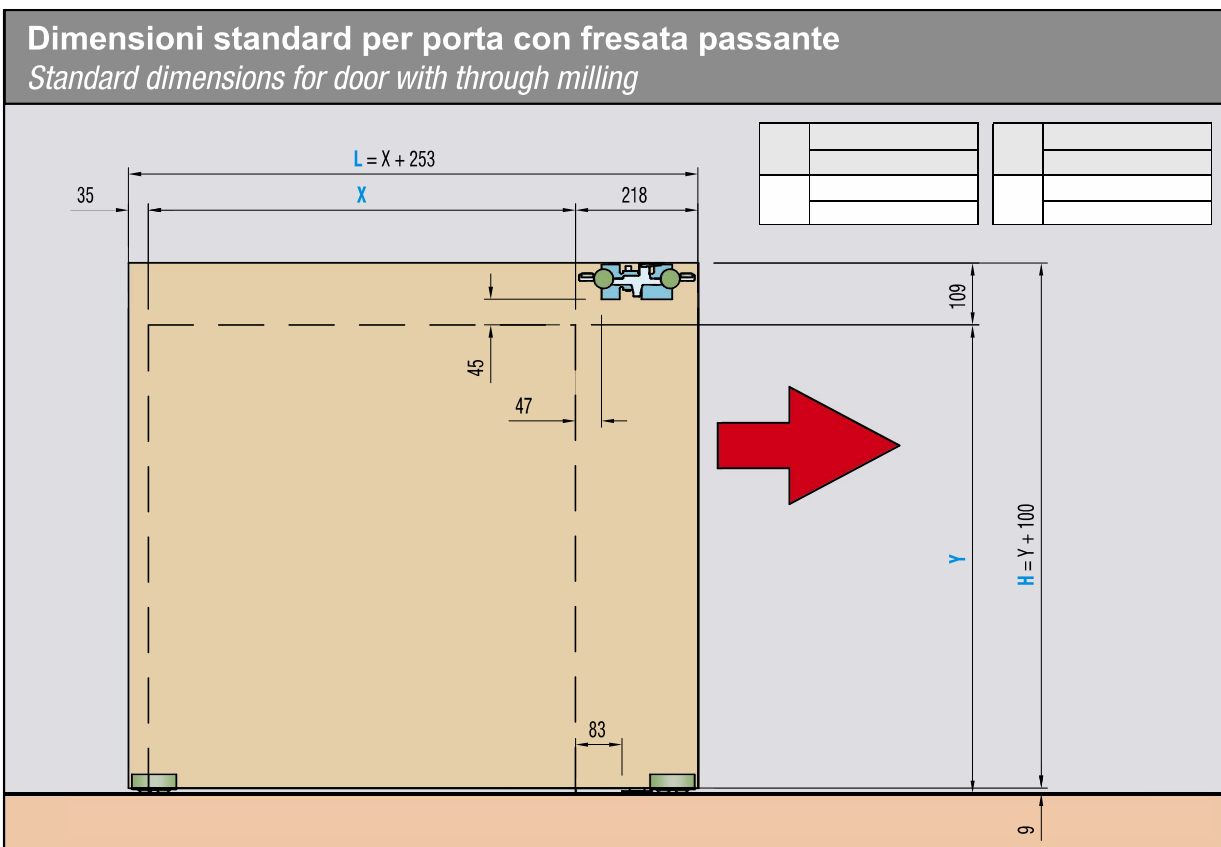

**Schema di foratura per porta con fresata passante**  
*Door drilling with through milling*

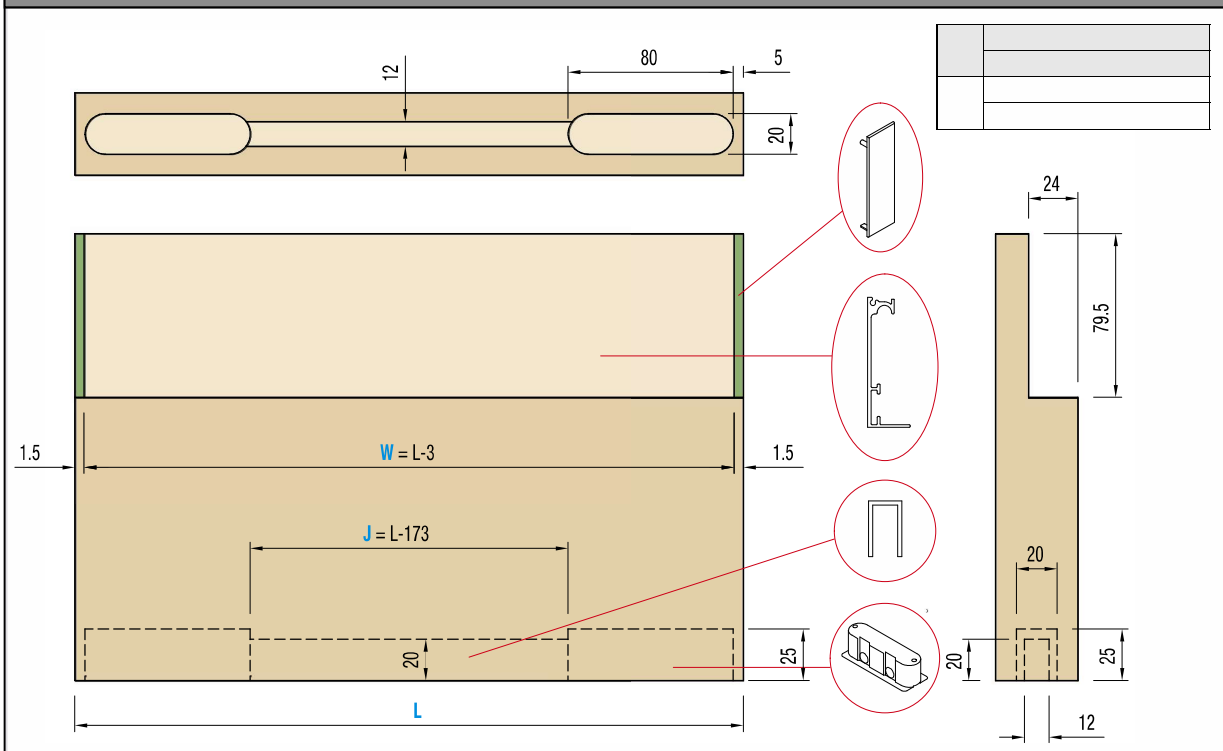

**Schema foratura per porta con fresata cieca**  
*Door drilling with blind milling*

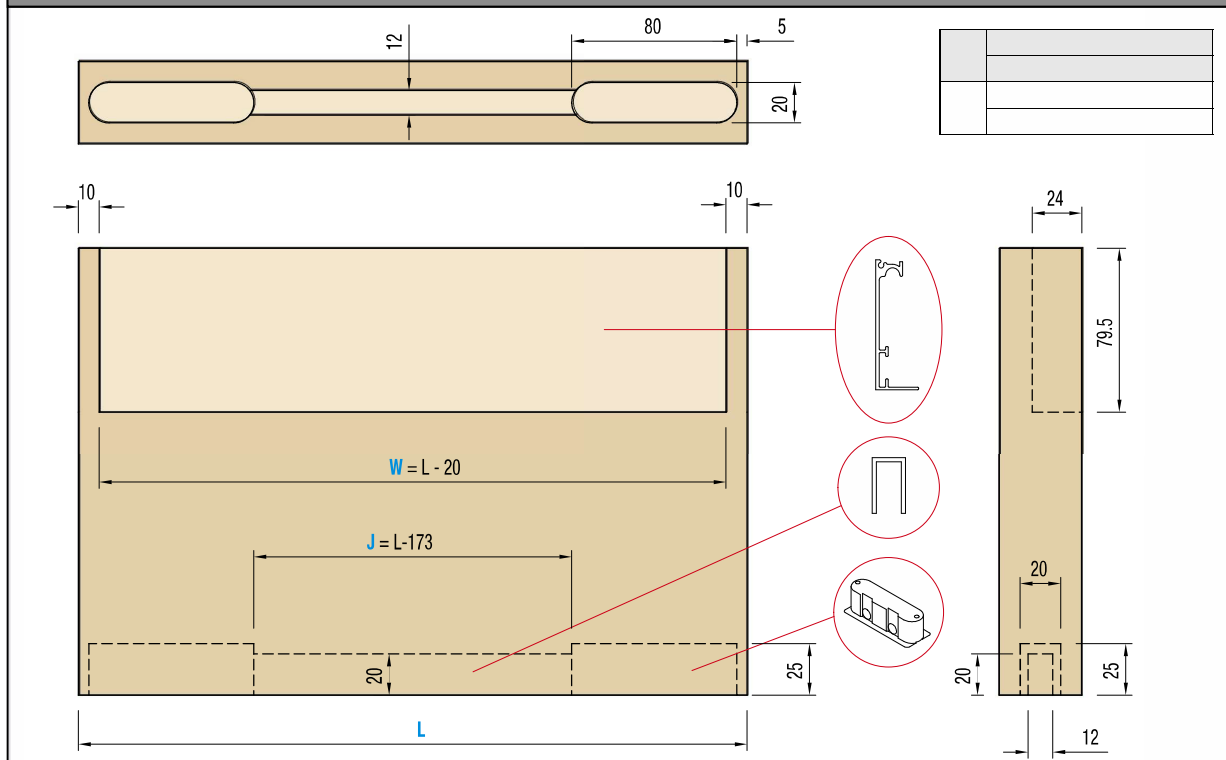

**Dispositivo di riarmo automatico / Automatic self activating device**

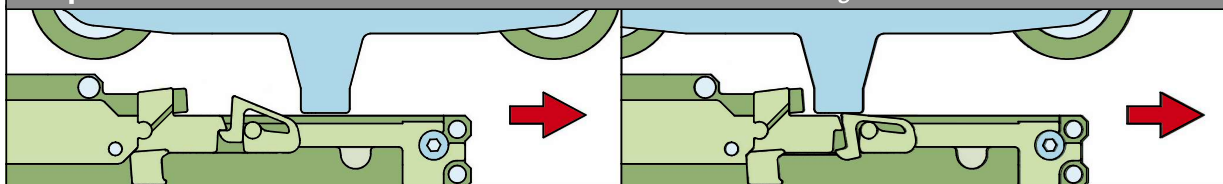

**Istruzioni di montaggio / Assembly instructions**

①

Posizionare la mezziera della porta in corrispondenza della guida fissata a muro. Controllare che l'antiscandalo non sia attivato come da figure sottostanti.  
*Fit the center line of the door close to the upper truck previously fastened to the wall. Check that the clasp is not triggered, as shown in the figures below.*

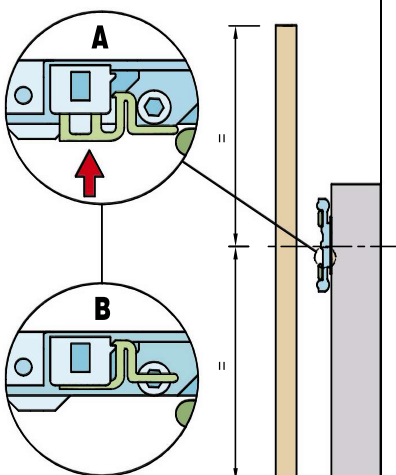

②

Posizionare la porta a cavallo della guida ART. 0106 facendo poggare a terra le ruote inferiori.  
*Position the door astride the runner ART. 0106 lying the lower wheels on the ground.*

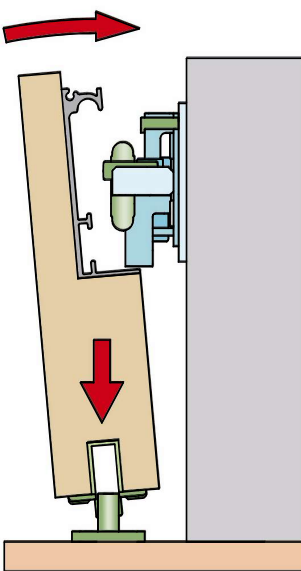

③

Mettere la porta in posizione verticale facendo poggiare il profilo alle ruote della staffa superiore. Mantenere la porta spinta contro la staffa superiore sino a fine montaggio.  
*Put the door in a vertical position, placing its profile on the wheels of the upper truck. Keep the door pushed against the upper truck till the end of the assembly.*

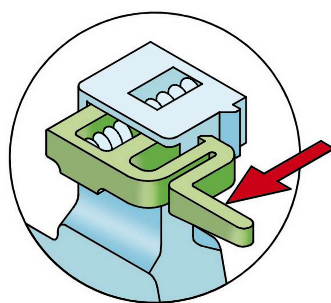
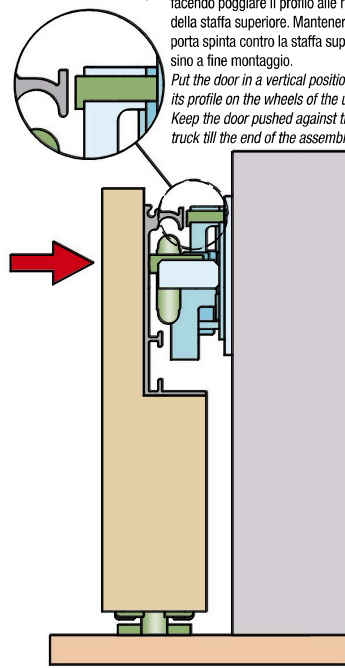

④ Tirare la leva dell'antiscandalo.  
*Pull the lever of the clasp.*

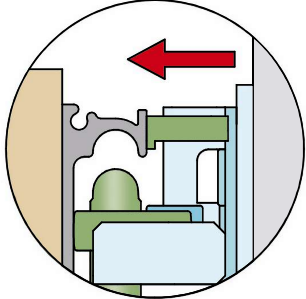

⑤ L'antiscandalo va automaticamente in appoggio al profilo superiore.  
*The clasp will automatically lie on the upper profile.*

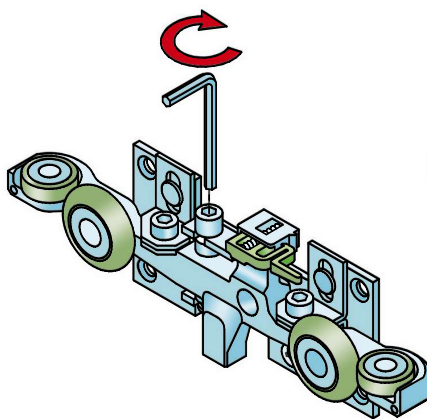

⑥ Avvitare la vite di regolazione della altezza della staffa a parete.  
*Fasten the screw for the adjustment of wall bracket height.*

Il bilanciere sale avvicinando le ruote al profilo.  
*The rocker arm rises, moving the wheels closer to the profile.*

Quando l'antiscandalo emette un sonoro Click, smettere di avvitare.  
*When the clasp makes a loud Click, stop fastening.*

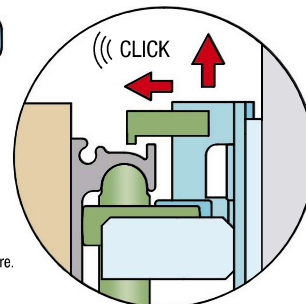
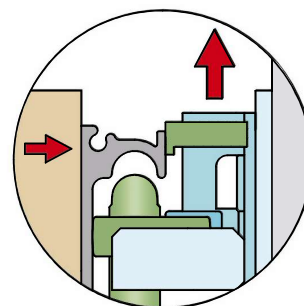

**Regolazione allineamento porta/muro / Door/Wall alignment adjustment**

7

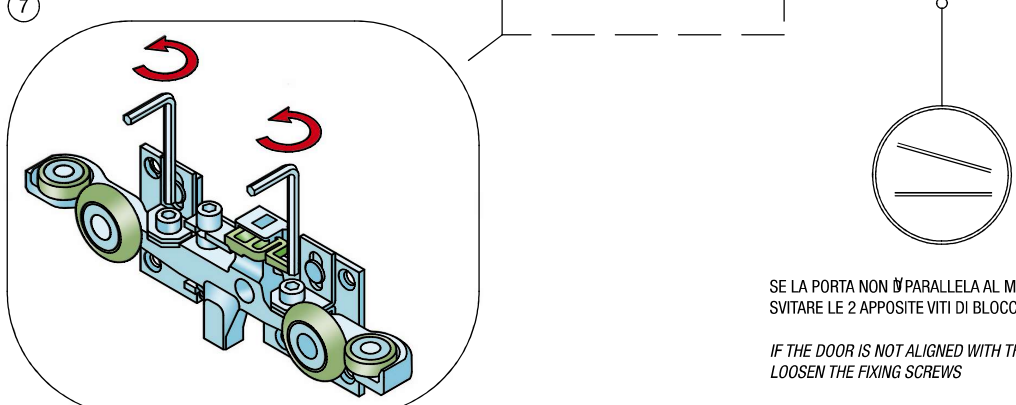

SE LA PORTA NON È PARALLELA AL MURO  
 SVITARE LE 2 APPOSITE VITI DI BLOCCAGGIO

IF THE DOOR IS NOT ALIGNED WITH THE WALL  
 LOOSEN THE FIXING SCREWS

8

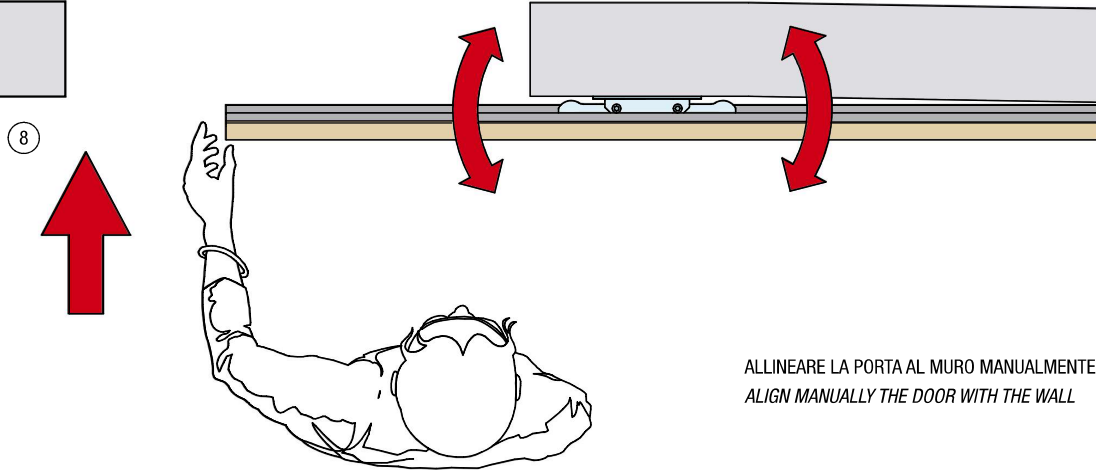

ALLINEARE LA PORTA AL MURO MANUALMENTE  
 ALIGN MANUALLY THE DOOR WITH THE WALL

9

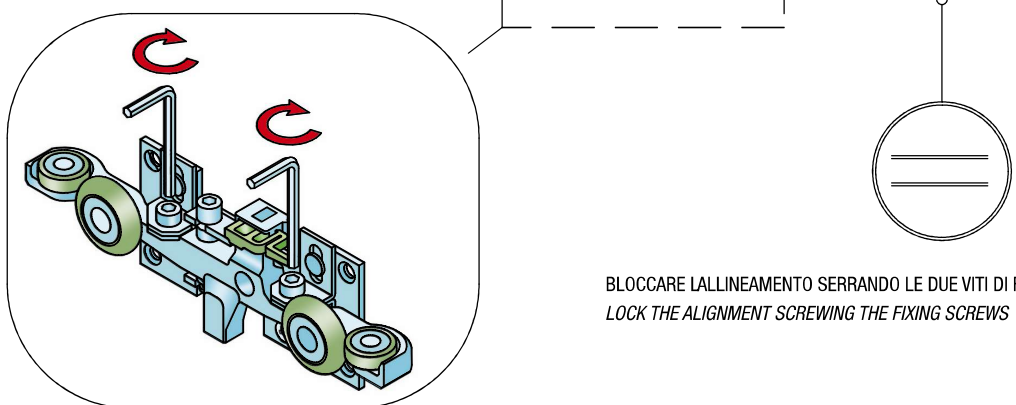

BLOCCARE L'ALLINEAMENTO SERRANDO LE DUE VITI DI FISSAGGIO  
 LOCK THE ALIGNMENT SCREWING THE FIXING SCREWS